

Baby Monitor Menu

To access the Baby Monitor Menu list press [MENU]



NOTE:

Navigation of the Menu in this tutorial is similar to the baby monitor menu settings with small variations.

Use the Navigator keys ►◄▲▼ to select items.

Use the [OK] button to confirm a Menu selection.

Use the [MENU] button to enter and exit programming.

MAIN MENU

Press ▲ or ▼ to select a menu item, press OK to confirm.



Press [MENU] to exit programming.

NOTE:

When multiple cameras are connected, [**Camera Select**] is the first menu option. In this tutorial camera select is the 12th item on the list.

MAIN MENU

Press ▲ or ▼ to select a menu item, press OK to confirm.



Press [MENU] to exit programming.

MAIN MENU

Press ▲ or ▼ to select a menu item, press OK to confirm.



Press [MENU] to exit programming.

MAIN MENU

Press ▲ or ▼ to select a menu item, press OK to confirm.



Press [MENU] to exit programming.

MAIN MENU

Press ▲ or ▼ to select a menu item, press OK to confirm.



Press [MENU] to exit programming.

MAIN MENU

Press ▲ or ▼ to select a menu item, press OK to confirm.



Press [MENU] to exit programming.

MAIN MENU

Press ▲ or ▼ to select a menu item, press OK to confirm.



Press [MENU] to exit programming.

MAIN MENU

Press ▲ or ▼ to select a menu item, press OK to confirm.



Press [MENU] to exit programming.

MAIN MENU

Press ▲ or ▼ to select a menu item, press OK to confirm.



Press [MENU] to exit programming.

MAIN MENU

Press ▲ or ▼ to select a menu item, press OK to confirm.



Press [MENU] to exit programming.

MAIN MENU

Press ▲ or ▼ to select a menu item, press OK to confirm.



Press [MENU] to exit programming.

MAIN MENU

Press ▲ or ▼ to select a menu item, press OK to confirm.



Press [MENU] to exit programming.

Camera Zoom

Press ◀ or ▶ to select 1X or 2X zoom ratio.



Press [MENU] to exit programming.

Camera Zoom

The camera zoom can be used to zoom in on images displayed on the monitor unit.

Camera Zoom

Press ◀ or ▶ to select 1X or 2X zoom ratio.



Press [MENU] to exit programming.

Camera Zoom

The camera zoom can be used to zoom in on images displayed on the monitor unit.

Lullaby

Press ▲ or ▼ to select a menu item, press OK to confirm.



Press [MENU] to exit programming.

Playing/Canceling Lullabies Manually

You can select from a range of lullabies and manually play them from the camera unit or cancel them.

Lullaby

Press ▲ or ▼ to select a menu item, press OK to confirm.



Press [MENU] to exit programming.

Playing/Canceling Lullabies Manually

You can select from a range of lullabies and manually play them from the camera unit or cancel them.

Lullaby - Sound List

Press ▲ or ▼ to select a Lullaby, press OK to confirm.



Sound List - Selecting a Lullaby

You can select from a range of lullabies.

Press [MENU] to exit programming.

Lullaby - Sound List

Press ▲ or ▼ to select a Lullaby, press OK to confirm.



Sound List - Selecting a Lullaby

You can select from a range of lullabies.

Press [MENU] to exit programming.

Lullaby - Sound List

Press ▲ or ▼ to select a Lullaby, press OK to confirm.



Sound List - Selecting a Lullaby

You can select from a range of lullabies.

Press [MENU] to exit programming.

Lullaby - Sound List

Press ▲ or ▼ to select a Lullaby, press OK to confirm.



Sound List - Selecting a Lullaby

You can select from a range of lullabies.

Press [MENU] to exit programming.

Lullaby - Sound List

Press ▲ or ▼ to select a Lullaby, press OK to confirm.



Press [MENU] to exit programming.

Sound List - Selecting a Lullaby

You can select from a range of lullabies.

Lullaby - Sound List

Press ▲ or ▼ to select a Lullaby, press OK to confirm.

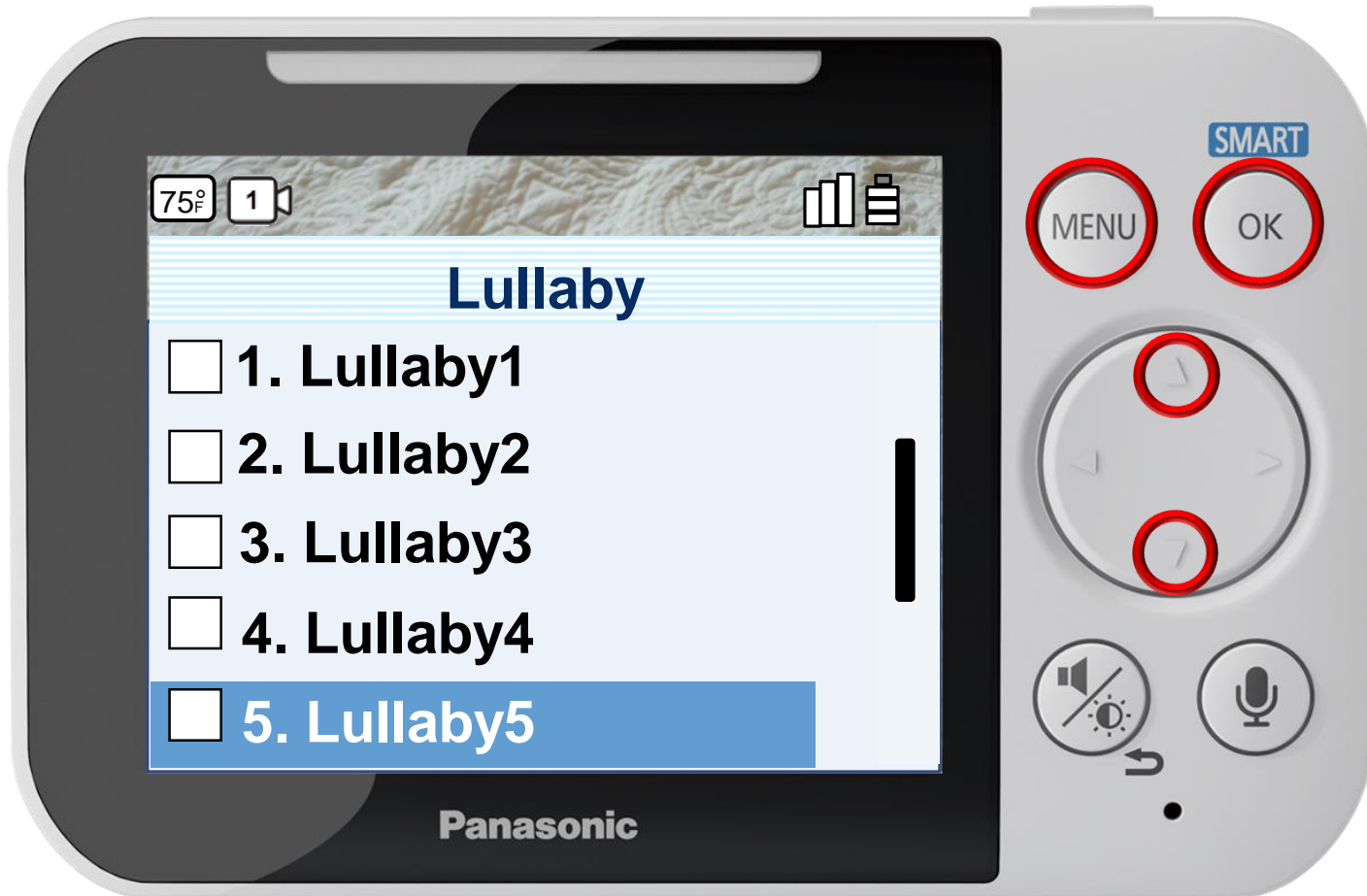

Sound List - Selecting a Lullaby

You can select from a range of lullabies.

Press [MENU] to exit programming.

Lullaby - Sound List

Press ▲ or ▼ to select a Lullaby, press OK to confirm.



Sound List - Selecting a Lullaby

You can select from a range of lullabies.

Press [MENU] to exit programming.

Lullaby - Sound List

Press ▲ or ▼ to select a Lullaby, press OK to confirm.



Sound List - Selecting a Lullaby

You can select from a range of lullabies.

Press [MENU] to exit programming.

Lullaby - Sound List

Press ▲ or ▼ to select a Lullaby, press OK to confirm.

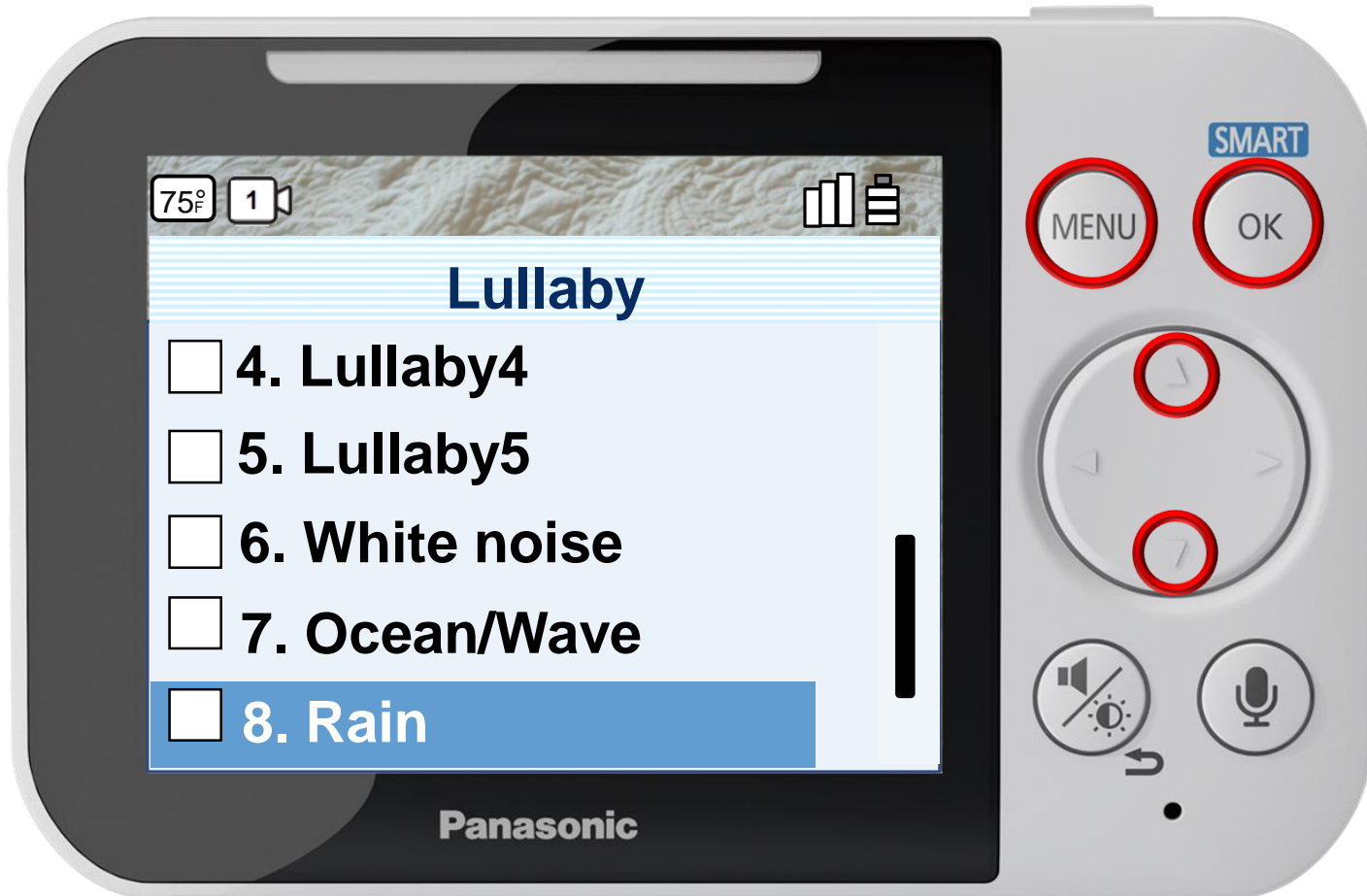

Sound List - Selecting a Lullaby

You can select from a range of lullabies.

Press [MENU] to exit programming.

Lullaby - Sound List

Press ▲ or ▼ to select a Lullaby, press OK to confirm.

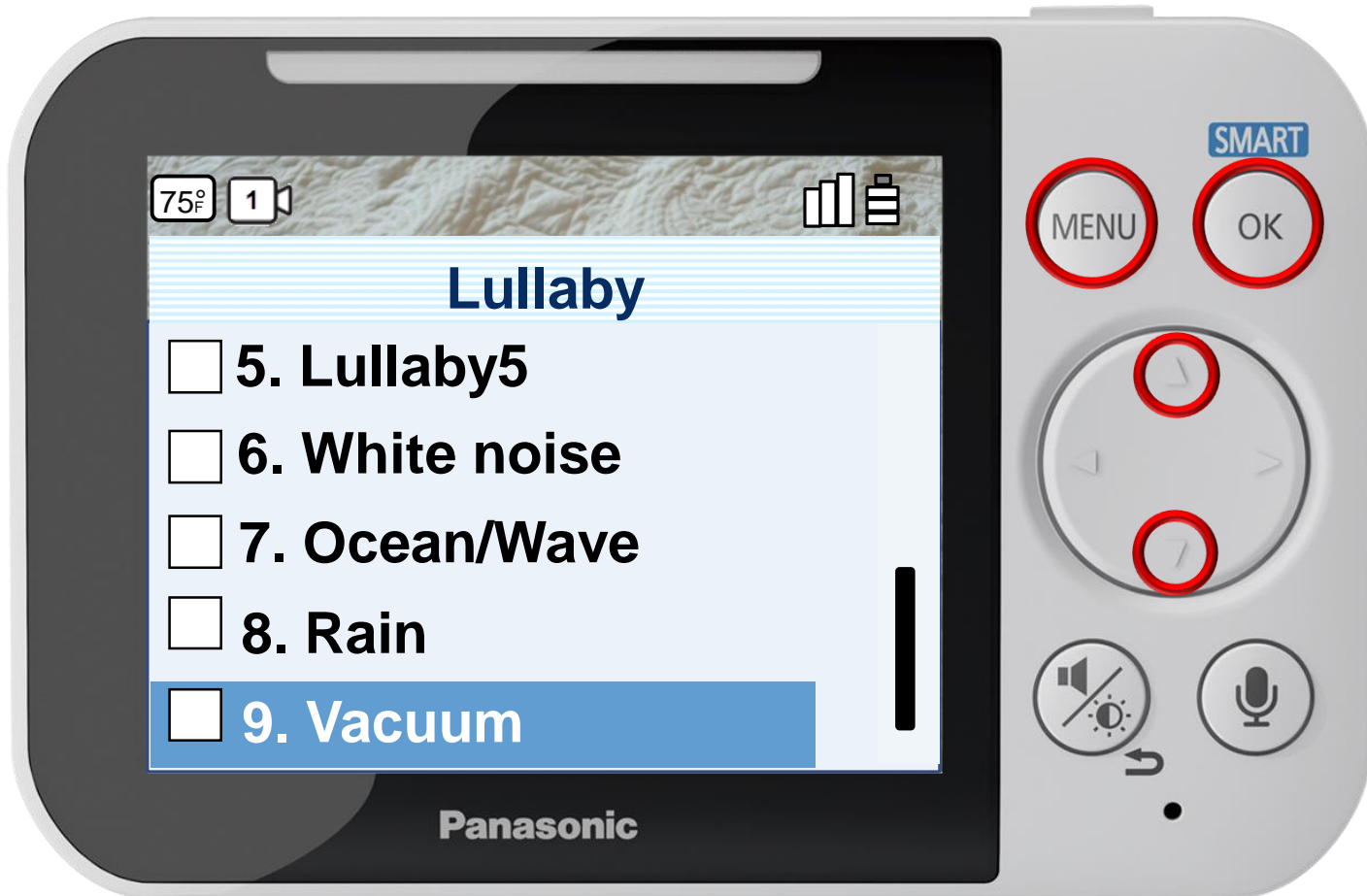

Sound List - Selecting a Lullaby

You can select from a range of lullabies.

Press [MENU] to exit programming.

Lullaby - Sound List

Press ▲ or ▼ to select a Lullaby, press OK to confirm.



Sound List - Selecting a Lullaby

You can select from a range of lullabies.

Press [MENU] to exit programming.

Lullaby - Play Time

Press ▲ or ▼ to select a play time, press OK to confirm.



Press [MENU] to exit programming.

Play Time

You can specify the time that lullabies play for.

Lullaby - Play Time

Press ▲ or ▼ to select a play time, press OK to confirm.



Press [MENU] to exit programming.

Play Time

You can specify the time that lullabies play for.

Lullaby - Play Time

Press ▲ or ▼ to select a play time, press OK to confirm.



Press [MENU] to exit programming.

Play Time

You can specify the time that lullabies play for.

Lullaby - Play Time

Press ▲ or ▼ to select a play time, press OK to confirm.



Press [MENU] to exit programming.

Play Time

You can specify the time that lullabies play for.

Lullaby - Play Time

Press ▲ or ▼ to select a play time, press OK to confirm.



Play Time

You can specify the time that lullabies play for.

Press [MENU] to exit programming.

Lullaby - Play Time

Press ▲ or ▼ to select a play time, press OK to confirm.



Play Time

You can specify the time that lullabies play for.

Press [MENU] to exit programming.

Lullaby - Play Time

Press ▲ or ▼ to select a play time, press OK to confirm.



Press [MENU] to exit programming.

Play Time

You can specify the time that lullabies play for.

Smart Notification

Press ▲ or ▼ to select a menu item, press OK to confirm.



Press [MENU] to exit programming.

Smart Notification

Specifies how the monitor notifies you when motion or sound is detected by the camera and configure motion detection.

Smart Notification

Press ▲ or ▼ to select a menu item, press OK to confirm.

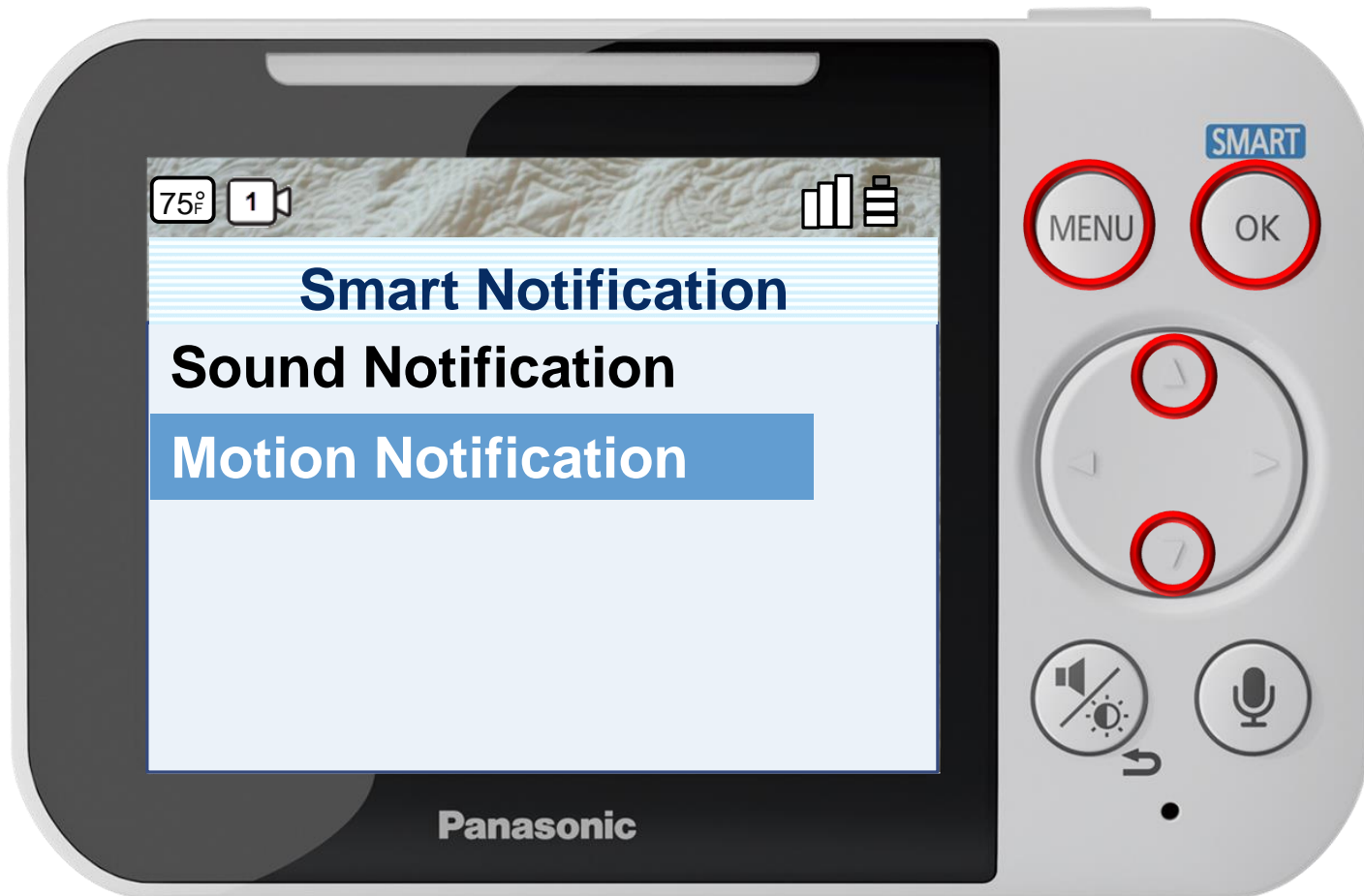

Press [MENU] to exit programming.

Smart Notification

Specifies how the monitor notifies you when motion or sound is detected by the camera and configure motion detection.

Smart Notification - Sound

Press ▲ or ▼ to select a notification, press OK to confirm.

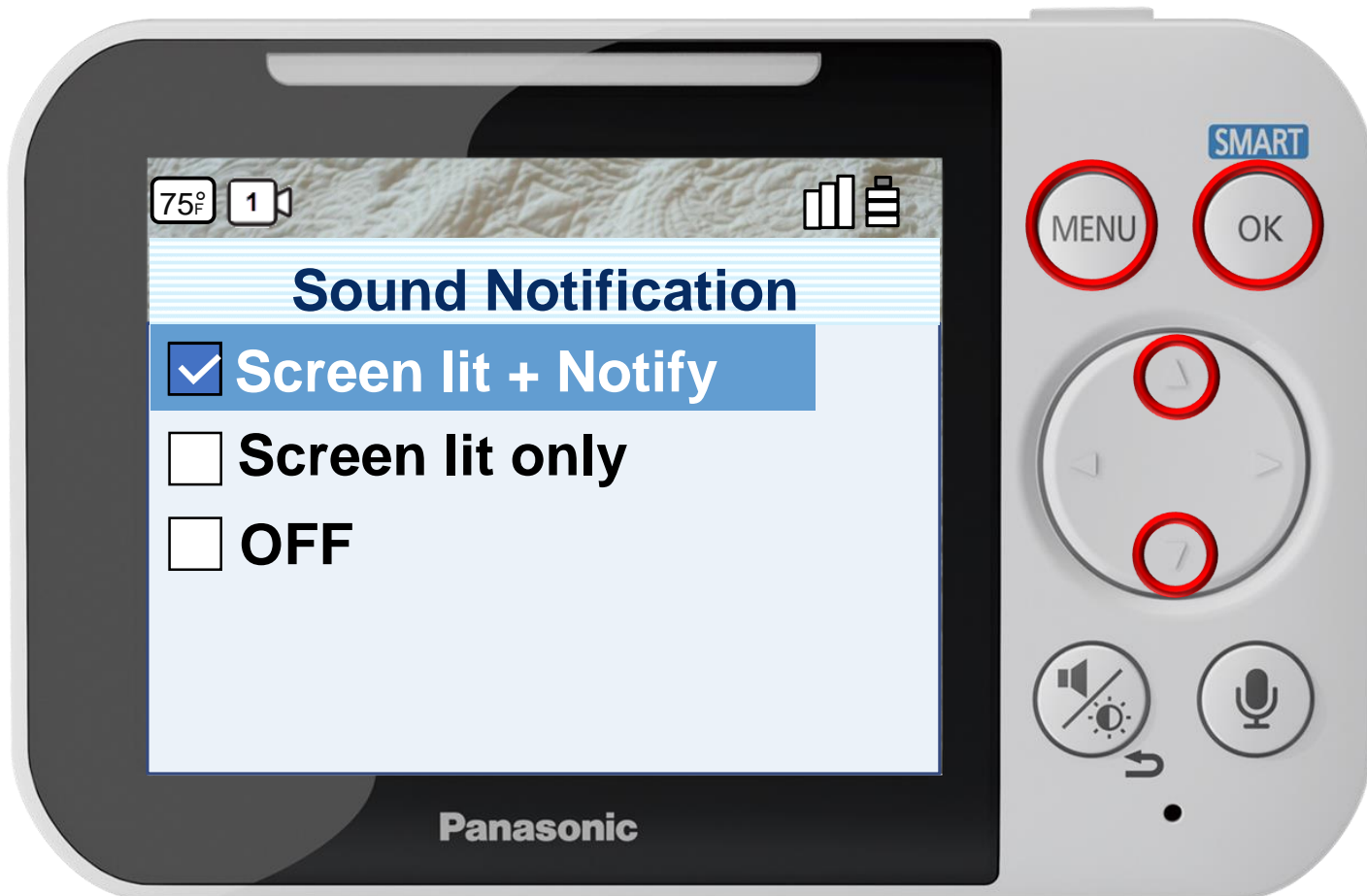

Press [MENU] to exit programming.

Configuring Sound Notifications

You can specify how the monitor notifies you when sound is detected or turn off notifications.

Smart Notification - Sound

Press ▲ or ▼ to select a notification, press OK to confirm.

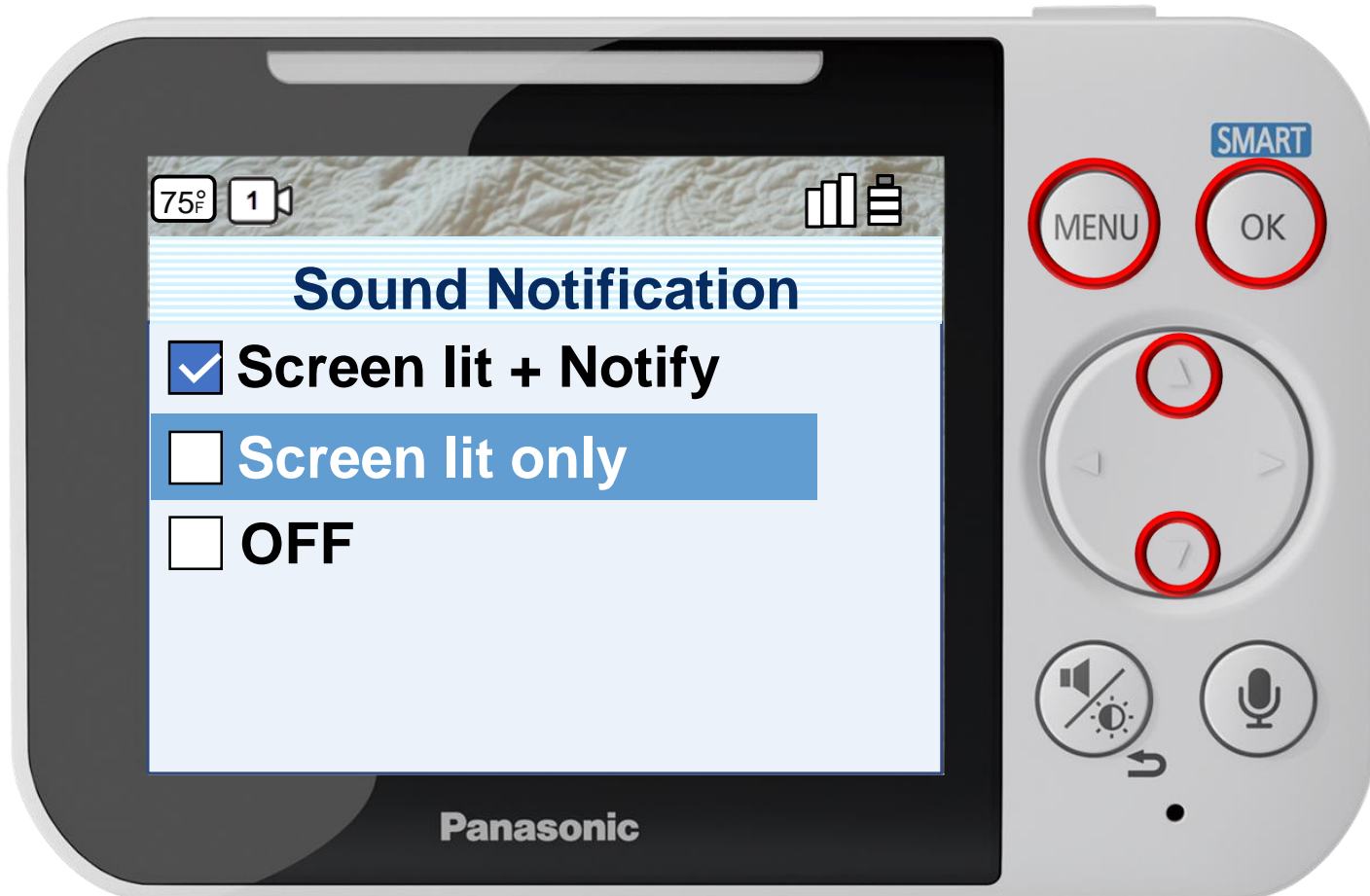

Press [MENU] to exit programming.

Configuring Sound Notifications

You can specify how the monitor notifies you when sound is detected or turn off notifications.

Smart Notification - Sound

Press ▲ or ▼ to select a notification, press OK to confirm.

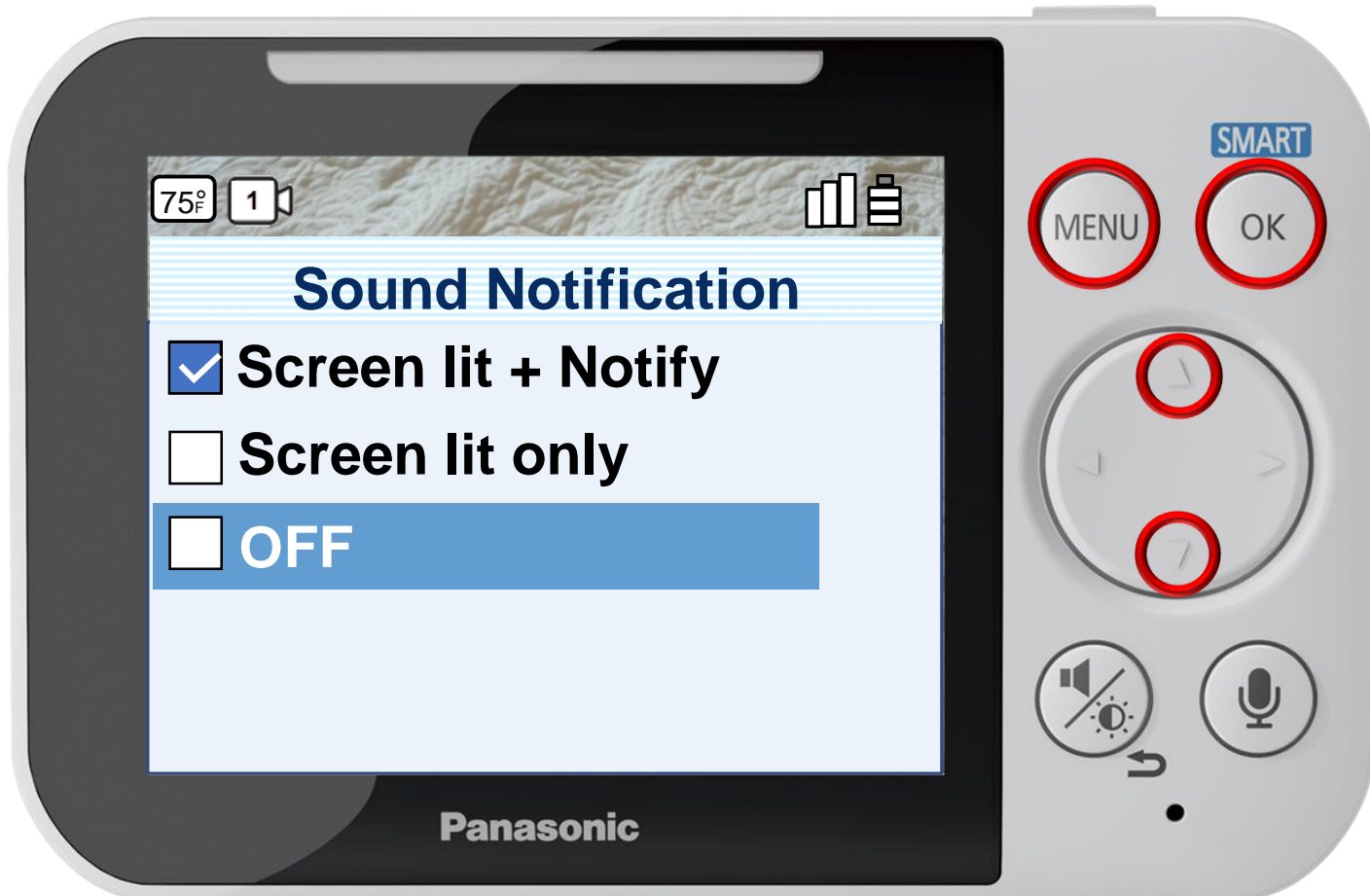

Press [MENU] to exit programming.

Configuring Sound Notifications

You can specify how the monitor notifies you when sound is detected or turn off notifications.

Smart Notification - Motion

Press ▲ or ▼ to select a notification, press OK to confirm.

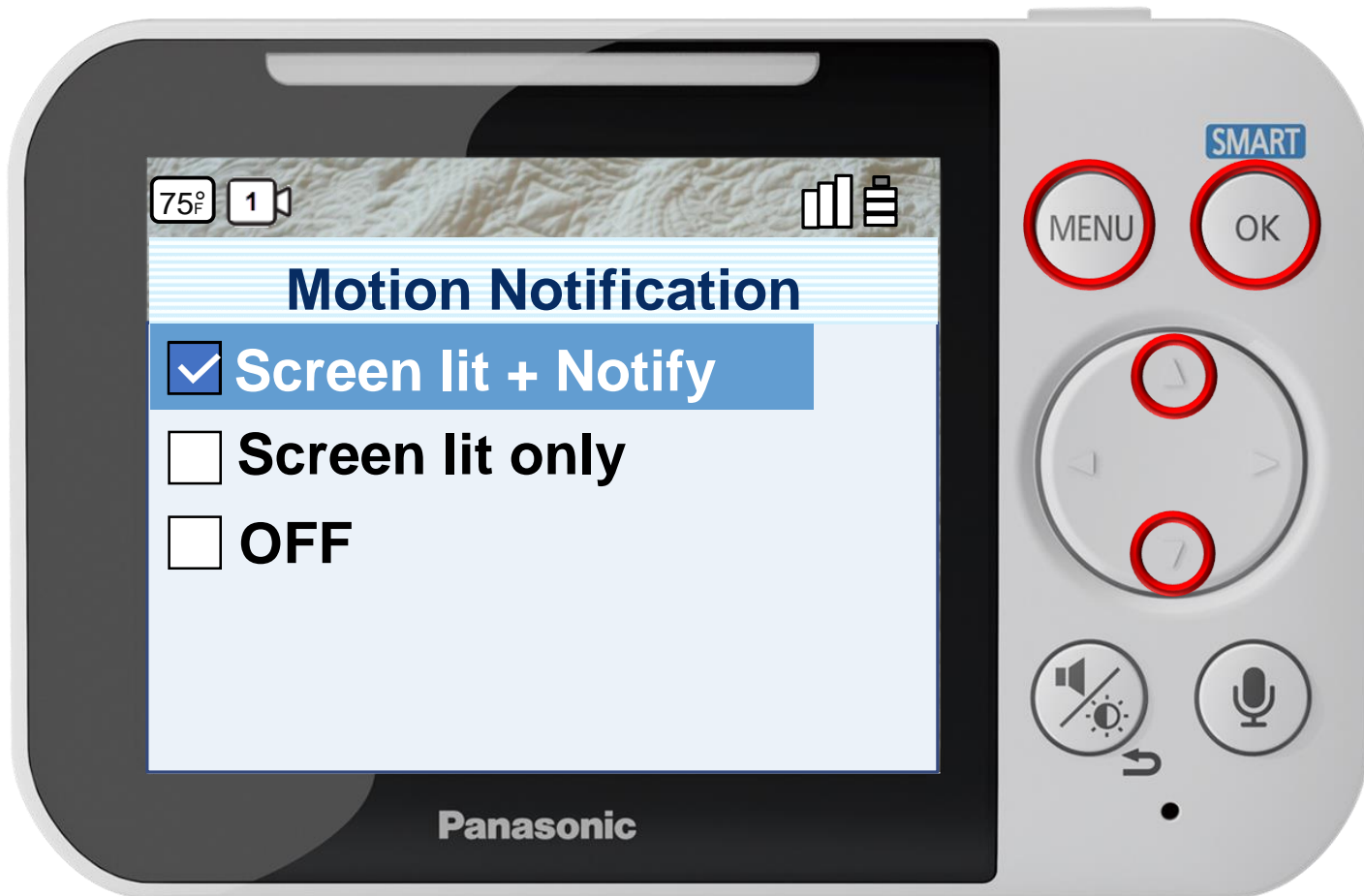

Press [MENU] to exit programming.

Configuring Motion Notifications

You can specify how the monitor notifies you when motion is detected or turn off notifications.

Smart Notification - Motion

Press ▲ or ▼ to select a notification, press OK to confirm.

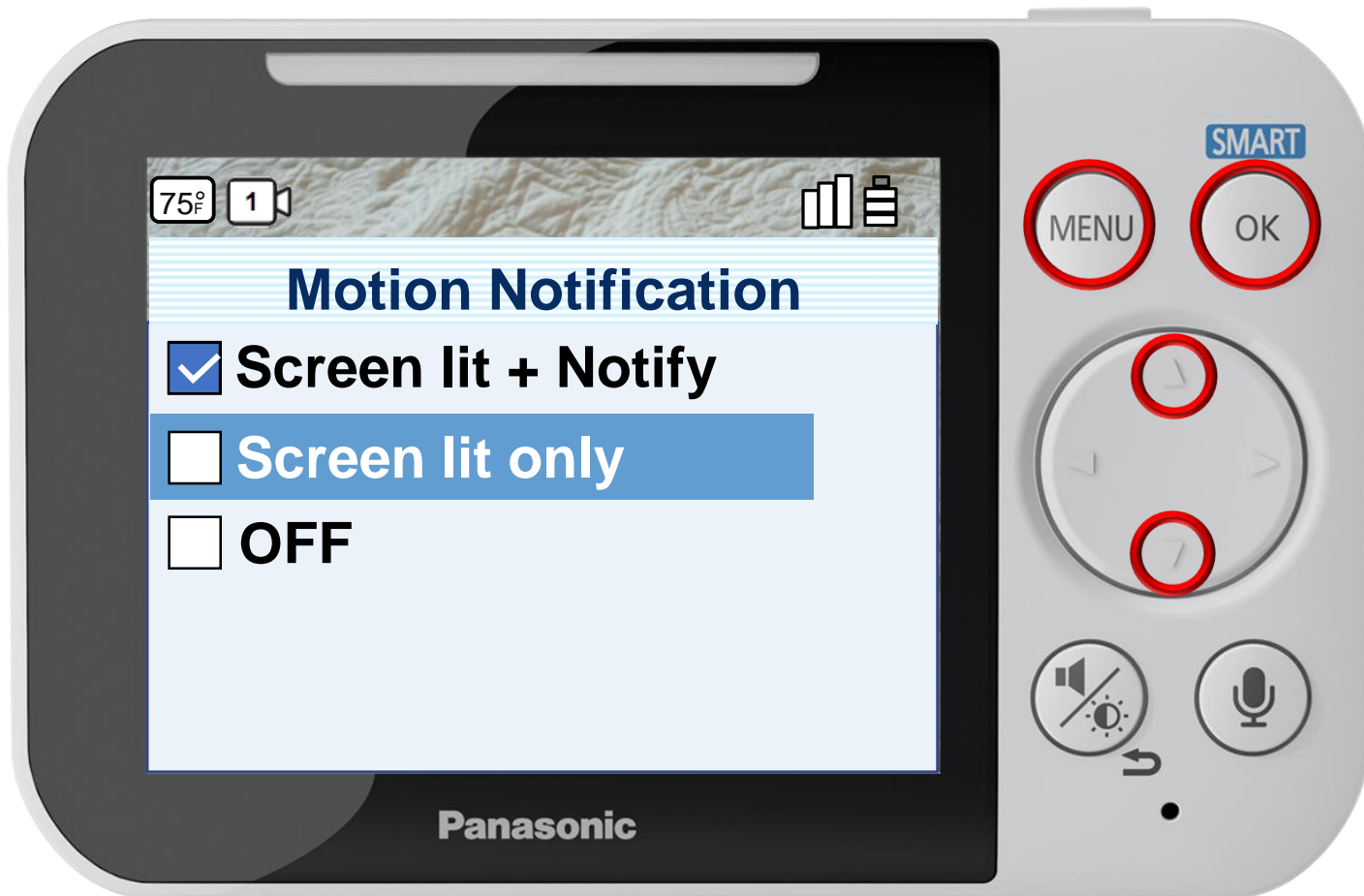

Press [MENU] to exit programming.

Configuring Motion Notifications

You can specify how the monitor notifies you when motion is detected or turn off notifications.

Smart Notification - Motion

Press ▲ or ▼ to select a notification, press OK to confirm.

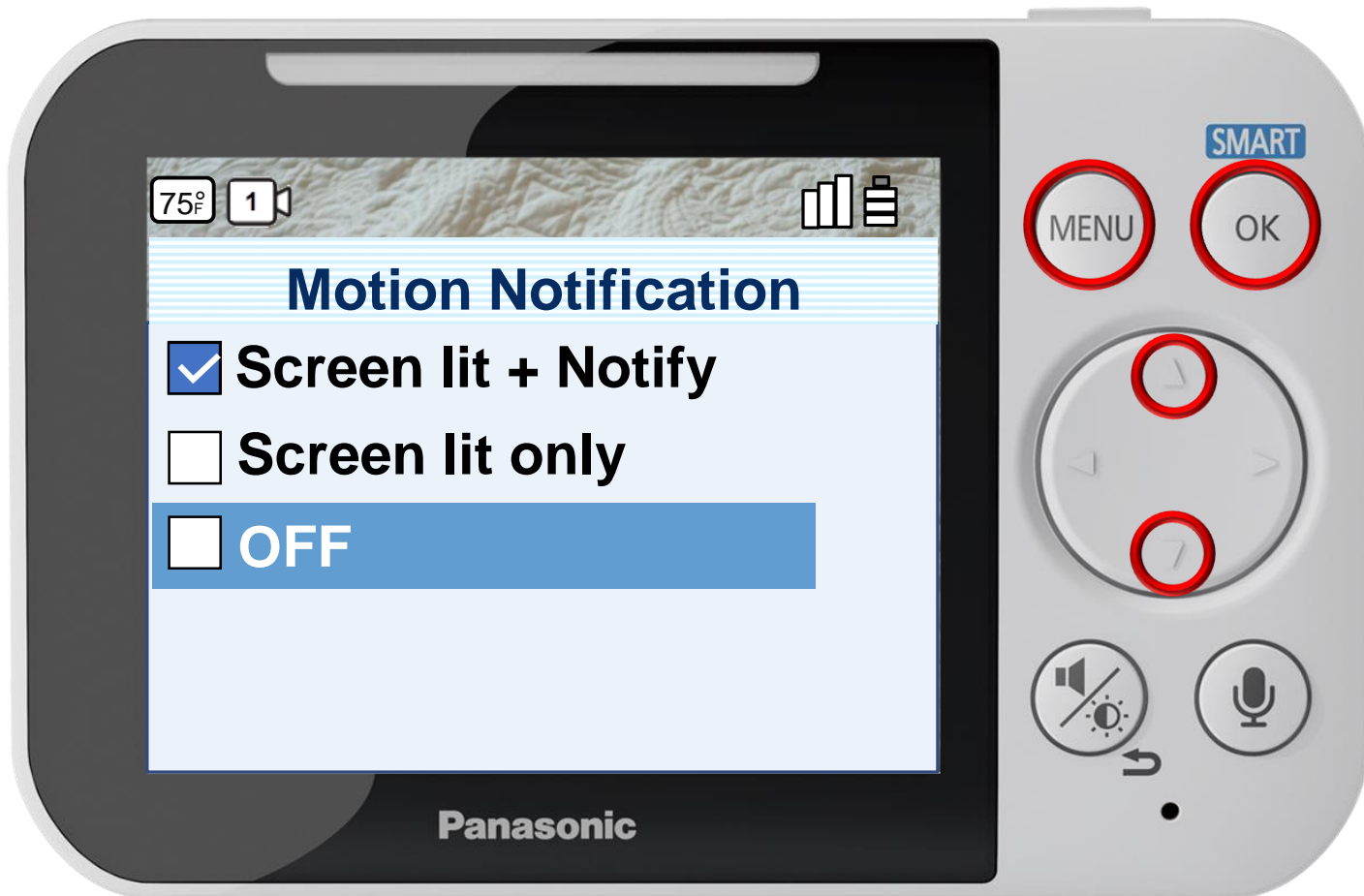

Press [MENU] to exit programming.

Configuring Motion Notifications

You can specify how the monitor notifies you when motion is detected or turn off notifications.

Auto Lullaby

Press ▲ or ▼ to select a menu item, press OK to confirm.



Press [MENU] to exit programming.

Auto Lullaby

You can configure lullabies to be played automatically from the camera when sound is detected.

Auto Lullaby

Press ▲ or ▼ to select a menu item, press OK to confirm.



Press [MENU] to exit programming.

Auto Lullaby

You can configure lullabies to be played automatically from the camera when sound is detected.

Auto Lullaby

Press ▲ or ▼ to select a menu item, press OK to confirm.



Press [MENU] to exit programming.

Auto Lullaby

You can configure lullabies to be played automatically from the camera when sound is detected.

Auto Lullaby

Press ▲ or ▼ to select a menu item, press OK to confirm.



Press [MENU] to exit programming.

Auto Lullaby

You can configure lullabies to be played automatically from the camera when sound is detected.

Auto Lullaby - Sound List

Press ▲ or ▼ to select a Lullaby, press OK to confirm.



Press [MENU] to exit programming.

Auto Lullaby

You can specify which lullaby is played when sound is detected or turn lullabies off.

Auto Lullaby - Sound List

Press ▲ or ▼ to select a Lullaby, press OK to confirm.



Press [MENU] to exit programming.

Auto Lullaby

You can specify which lullaby is played when sound is detected or turn lullabies off.

Auto Lullaby - Sound List

Press ▲ or ▼ to select a Lullaby, press OK to confirm.



Press [MENU] to exit programming.

Auto Lullaby

You can specify which lullaby is played when sound is detected or turn lullabies off.

Auto Lullaby - Sound List

Press ▲ or ▼ to select a Lullaby, press OK to confirm.



Press [MENU] to exit programming.

Auto Lullaby

You can specify which lullaby is played when sound is detected or turn lullabies off.

Auto Lullaby - Sound List

Press ▲ or ▼ to select a Lullaby, press OK to confirm.



Press [MENU] to exit programming.

Auto Lullaby

You can specify which lullaby is played when sound is detected or turn lullabies off.

Auto Lullaby - Sound List

Press ▲ or ▼ to select a Lullaby, press OK to confirm.



Press [MENU] to exit programming.

Auto Lullaby

You can specify which lullaby is played when sound is detected or turn lullabies off.

Auto Lullaby - Sound List

Press ▲ or ▼ to select a Lullaby, press OK to confirm.



Press [MENU] to exit programming.

Auto Lullaby

You can specify which lullaby is played when sound is detected or turn lullabies off.

Auto Lullaby - Sound List

Press ▲ or ▼ to select a Lullaby, press OK to confirm.



Press [MENU] to exit programming.

Auto Lullaby

You can specify which lullaby is played when sound is detected or turn lullabies off.

Auto Lullaby - Sound List

Press ▲ or ▼ to select a Lullaby, press OK to confirm.



Press [MENU] to exit programming.

Auto Lullaby

You can specify which lullaby is played when sound is detected or turn lullabies off.

Auto Lullaby - Sound List

Press ▲ or ▼ to select a Lullaby, press OK to confirm.

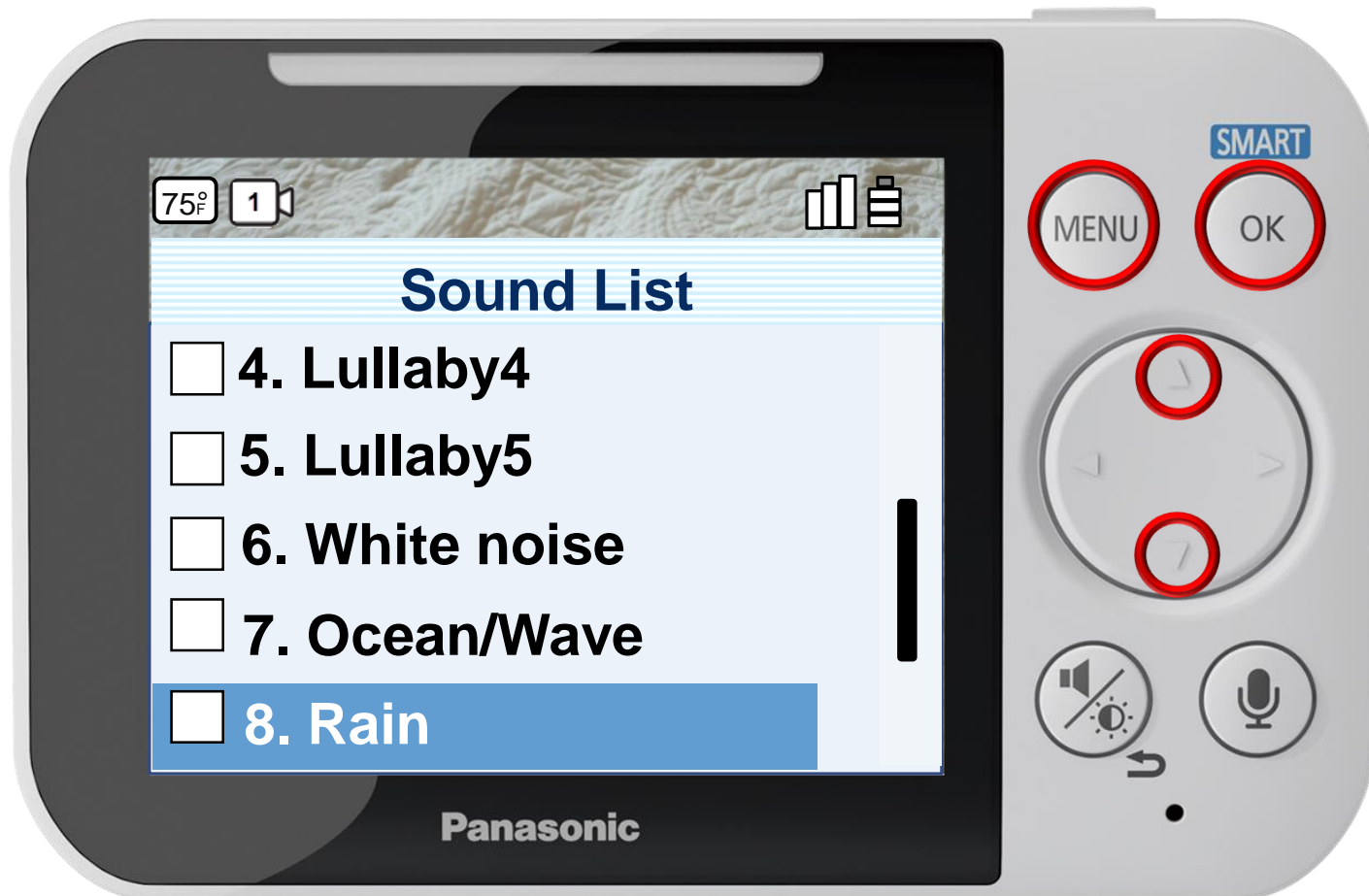

Press [MENU] to exit programming.

Auto Lullaby

You can specify which lullaby is played when sound is detected or turn lullabies off.

Auto Lullaby - Sound List

Press ▲ or ▼ to select a Lullaby, press OK to confirm.

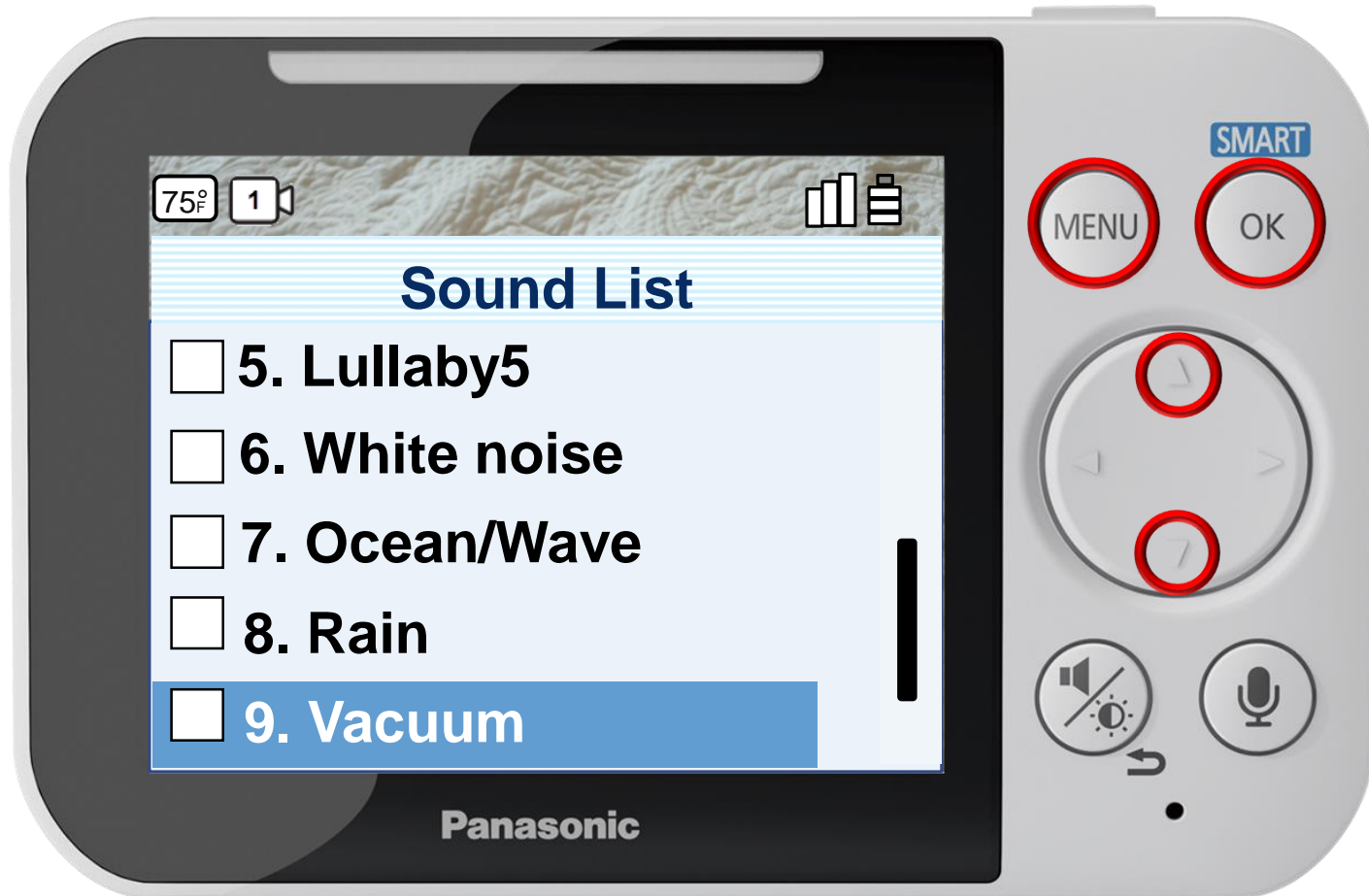

Press [MENU] to exit programming.

Auto Lullaby

You can specify which lullaby is played when sound is detected or turn lullabies off.

Auto Lullaby - Sound List

Press ▲ or ▼ to select a Lullaby, press OK to confirm.



Press [MENU] to exit programming.

Auto Lullaby

You can specify which lullaby is played when sound is detected or turn lullabies off.

Auto Lullaby – Sound Detect Level

Press ▲ or ▼ to select a level, press OK to confirm.

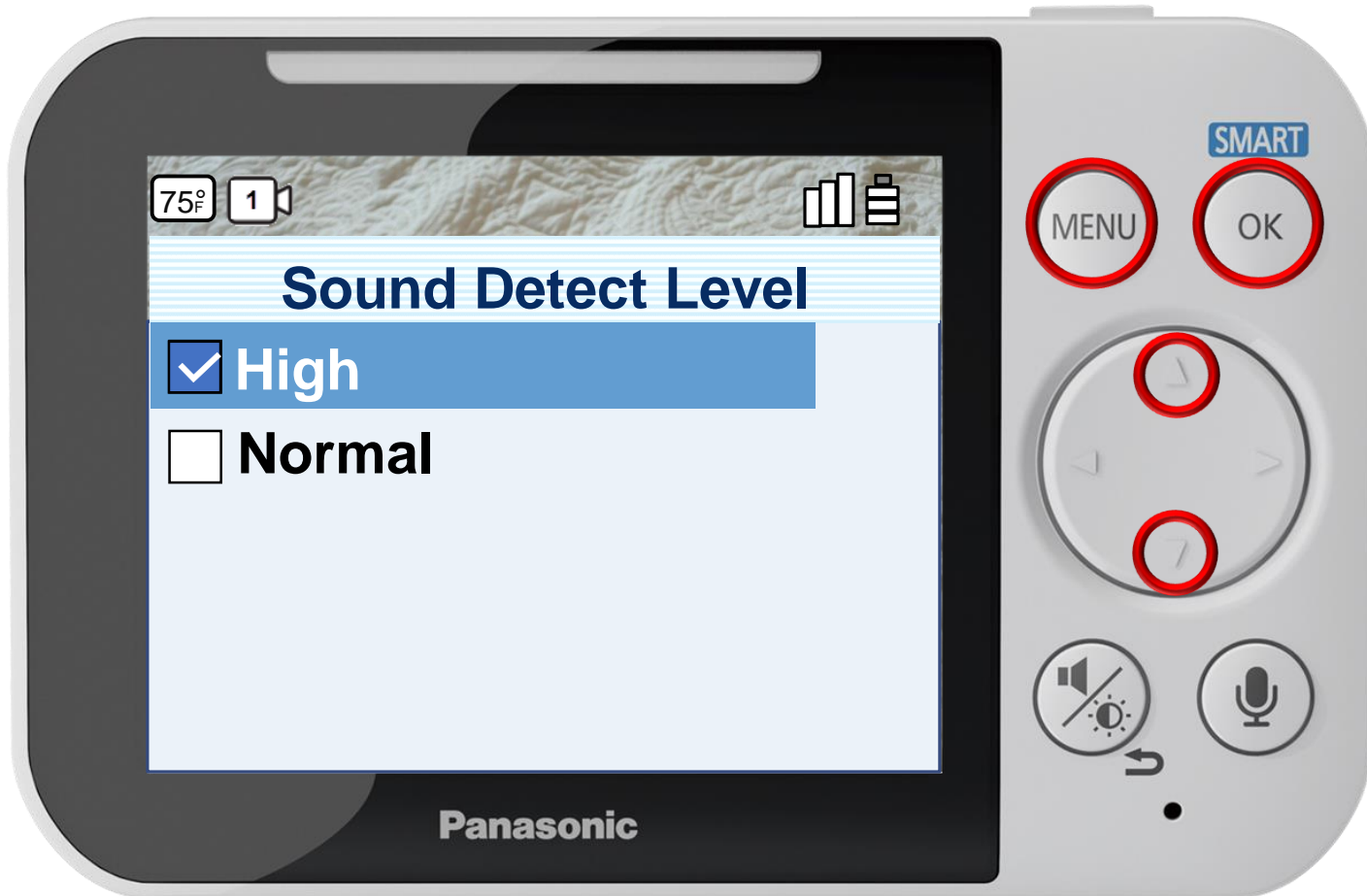

Press [MENU] to exit programming.

Sound Detection Level

You can adjust the level at which sound is detected. Increase or decrease the detection level needed to trigger the sound sensor.

Auto Lullaby – Sound Detect Level

Press ▲ or ▼ to select a level, press OK to confirm.

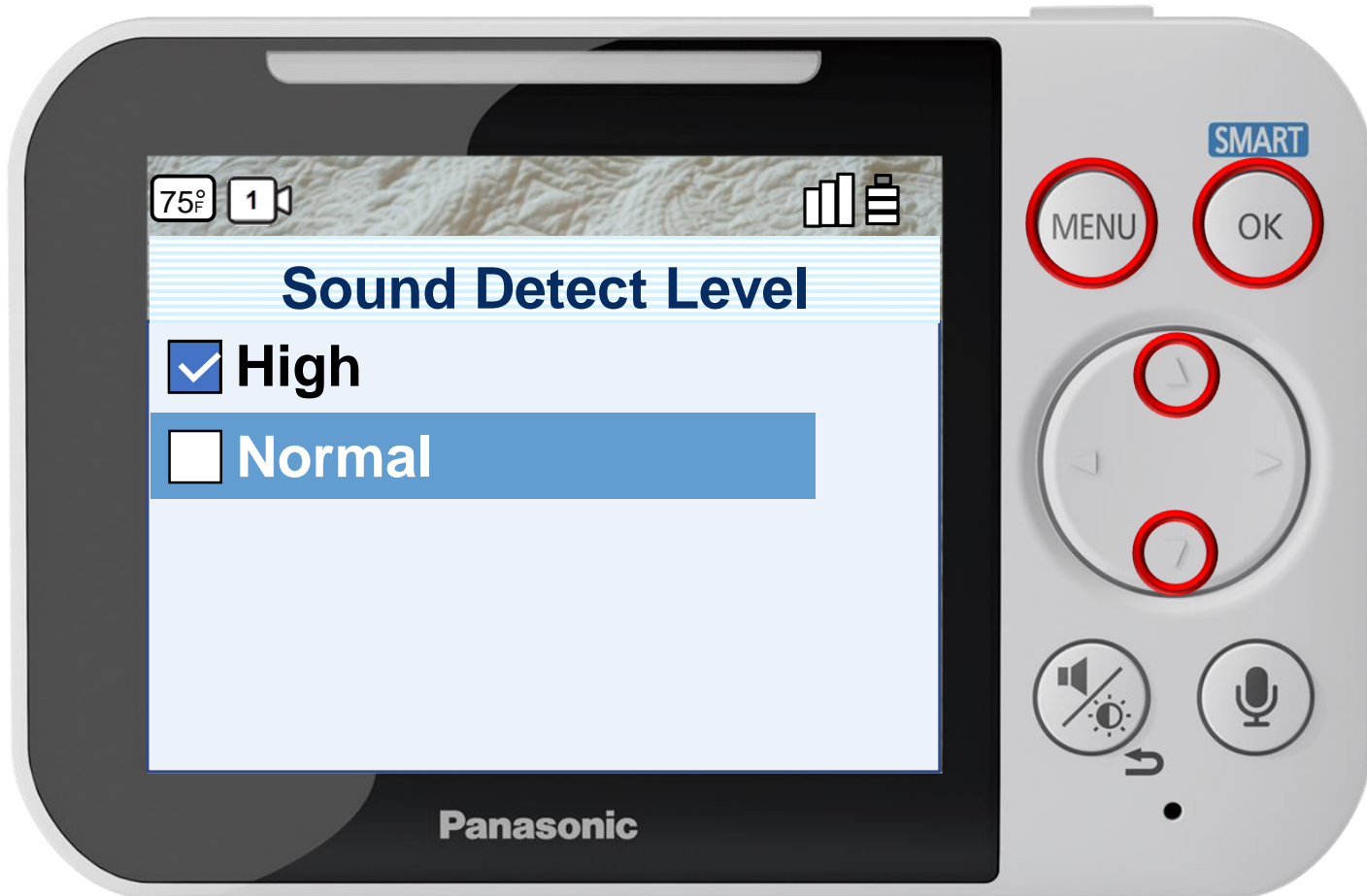

Press [MENU] to exit programming.

Sound Detection Level

You can adjust the level at which sound is detected. Increase or decrease the detection level needed to trigger the sound sensor.

Auto Lullaby – Detection Time

Press ▲ or ▼ to select a play time, press OK to confirm.

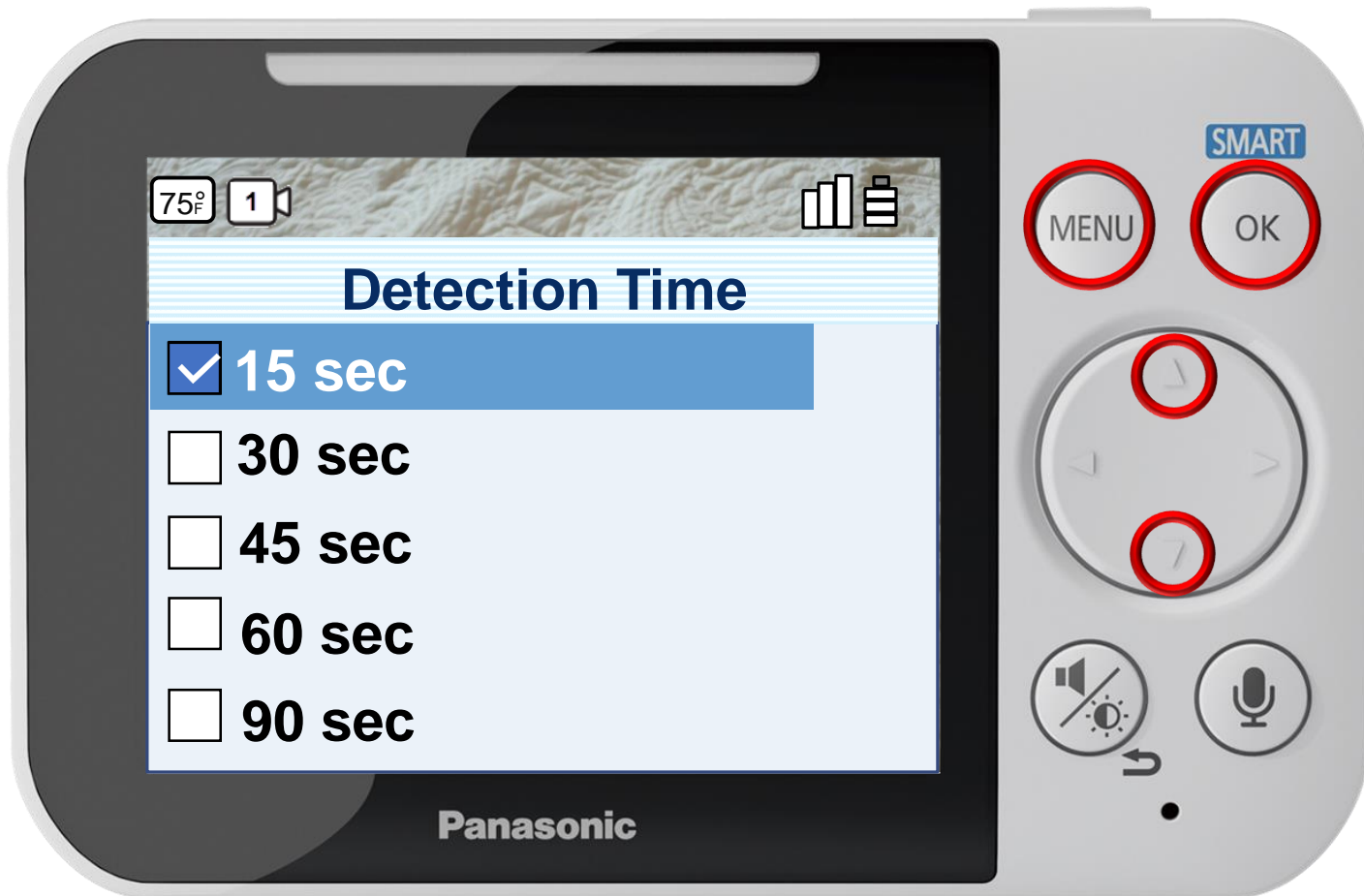

Press [MENU] to exit programming.

Play Time

You can specify how long the camera plays lullabies when sound is detected.

Auto Lullaby – Detection Time

Press ▲ or ▼ to select a play time, press OK to confirm.

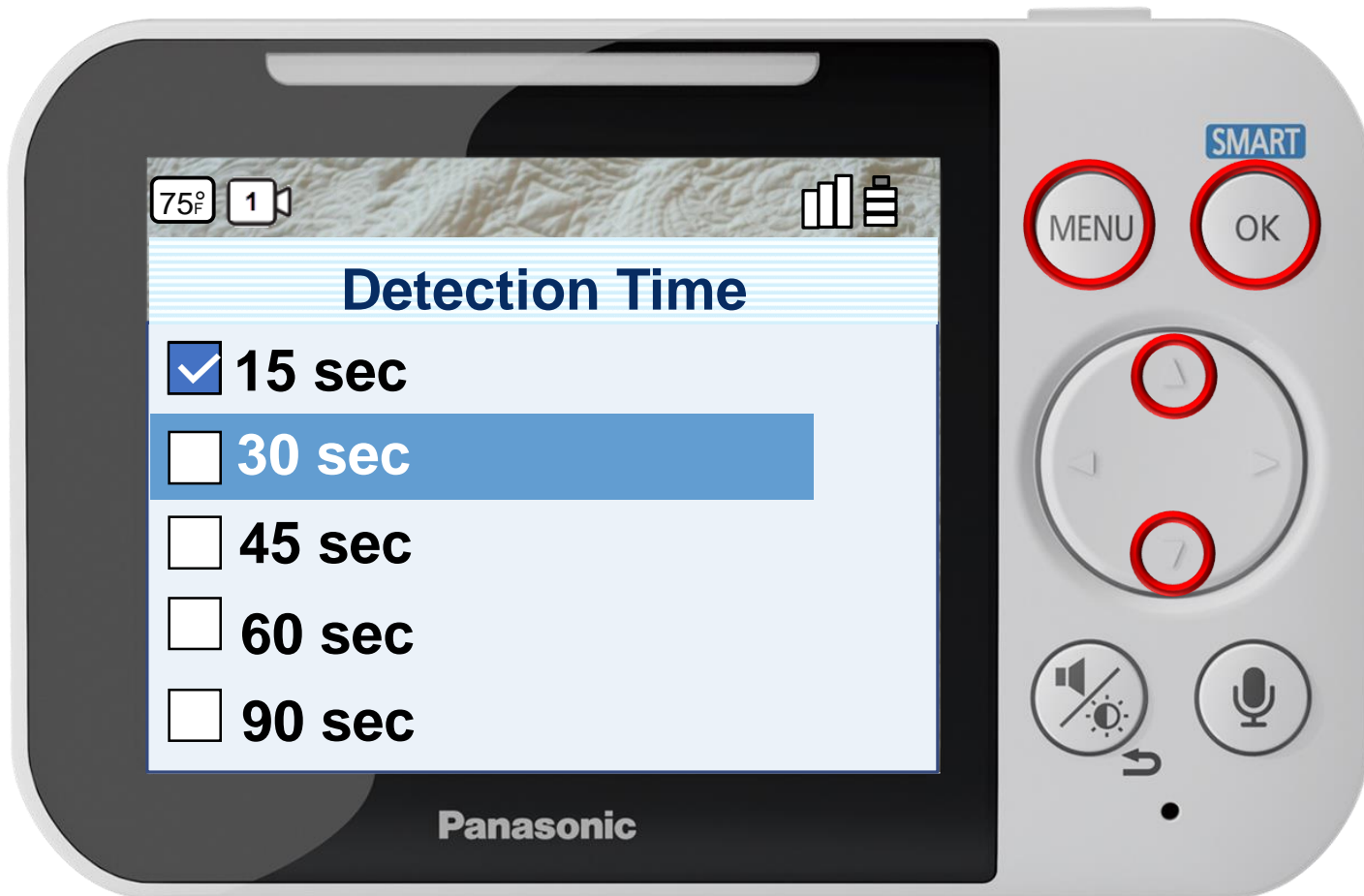

Press [MENU] to exit programming.

Play Time

You can specify how long the camera plays lullabies when sound is detected.

Auto Lullaby – Detection Time

Press ▲ or ▼ to select a play time, press OK to confirm.

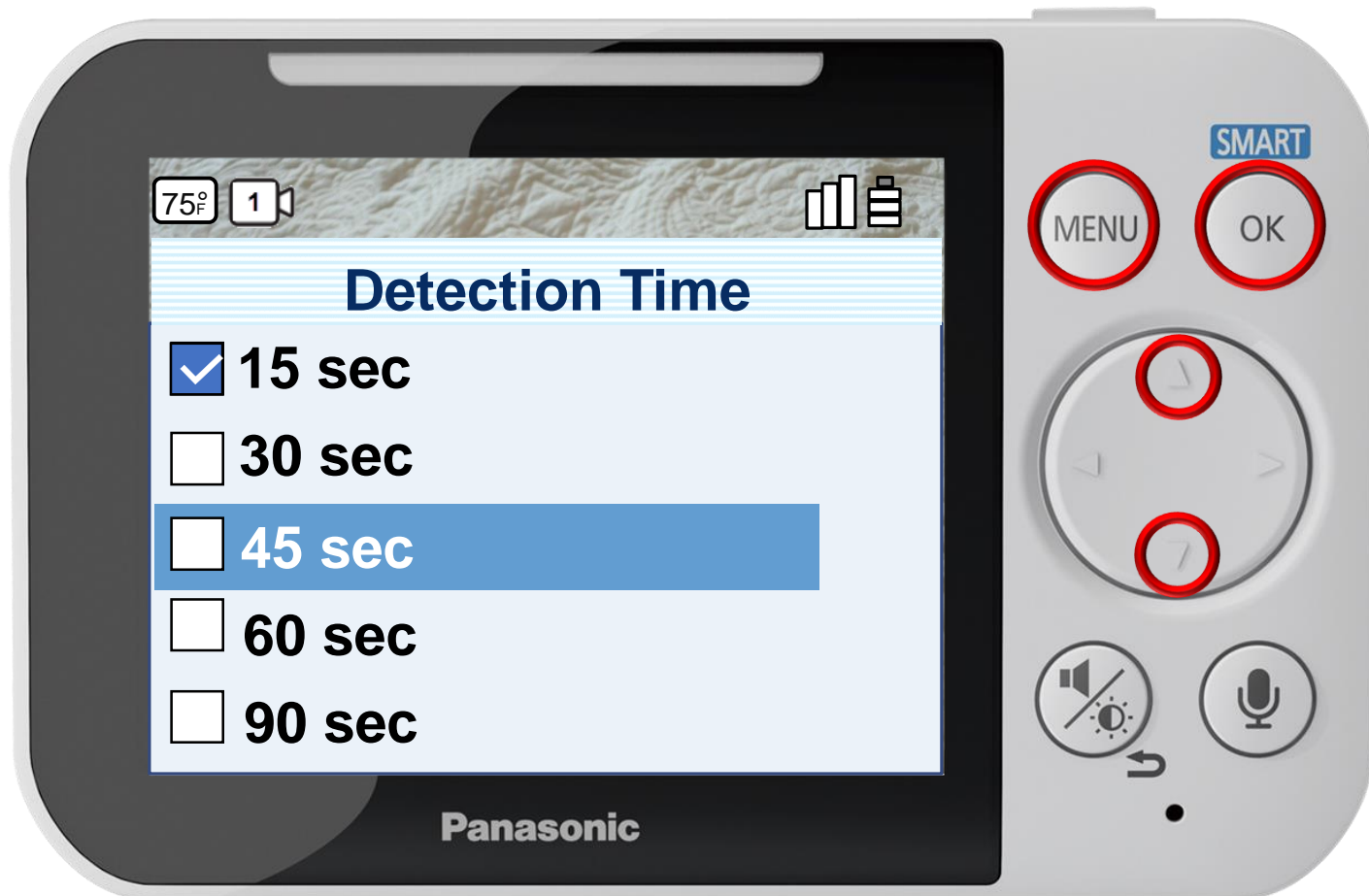

Press [MENU] to exit programming.

Play Time

You can specify how long the camera plays lullabies when sound is detected.

Auto Lullaby – Detection Time

Press ▲ or ▼ to select a play time, press OK to confirm.



Press [MENU] to exit programming.

Play Time

You can specify how long the camera plays lullabies when sound is detected.

Auto Lullaby – Detection Time

Press ▲ or ▼ to select a play time, press OK to confirm.

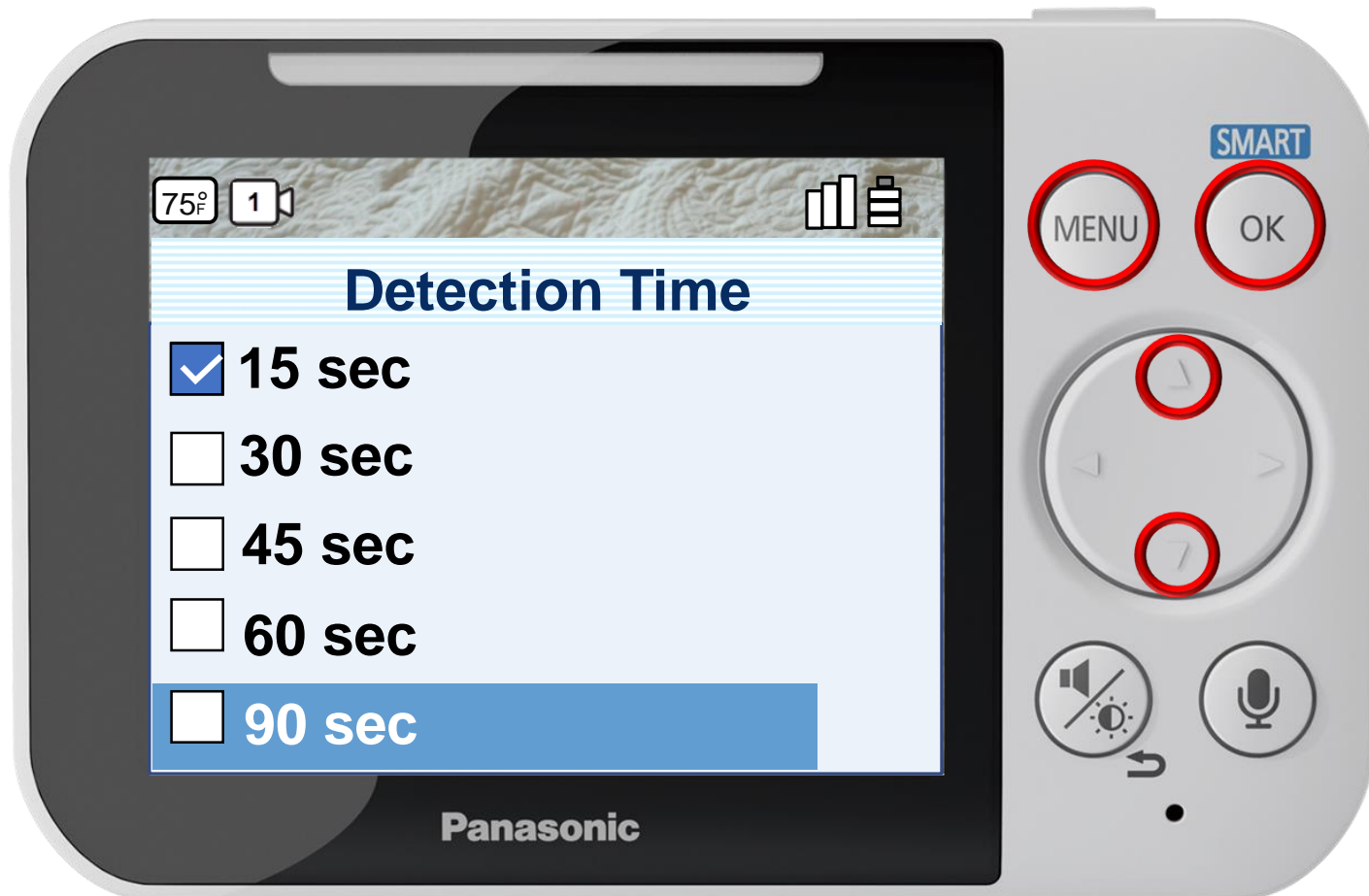

Press [MENU] to exit programming.

Play Time

You can specify how long the camera plays lullabies when sound is detected.

Auto Lullaby - Play Time

Press ▲ or ▼ to select a play time, press OK to confirm.



Press [MENU] to exit programming.

Play Time

You can specify how long the camera plays lullabies when sound is detected.

Auto Lullaby - Play Time

Press ▲ or ▼ to select a play time, press OK to confirm.



Press [MENU] to exit programming.

Play Time

You can specify how long the camera plays lullabies when sound is detected.

Auto Lullaby - Play Time

Press ▲ or ▼ to select a play time, press OK to confirm.



Press [MENU] to exit programming.

Play Time

You can specify how long the camera plays lullabies when sound is detected.

Auto Lullaby - Play Time

Press ▲ or ▼ to select a play time, press OK to confirm.



Press [MENU] to exit programming.

Play Time

You can specify how long the camera plays lullabies when sound is detected.

Auto Lullaby - Play Time

Press ▲ or ▼ to select a play time, press OK to confirm.



Press [MENU] to exit programming.

Play Time

You can specify how long the camera plays lullabies when sound is detected.

Auto Lullaby - Play Time

Press ▲ or ▼ to select a play time, press OK to confirm.



Press [MENU] to exit programming.

Play Time

You can specify how long the camera plays lullabies when sound is detected.

Auto Lullaby - Play Time

Press ▲ or ▼ to select a play time, press OK to confirm.



Press [MENU] to exit programming.

Play Time

You can specify how long the camera plays lullabies when sound is detected.

Auto Lullaby - Play Time

Press ▲ or ▼ to select a play time, press OK to confirm.



Press [MENU] to exit programming.

Play Time

You can specify how long the camera plays lullabies when sound is detected.

Timer

Press ▲ or ▼ to select a setting, press OK to confirm.



Press [MENU] to exit programming.

Timer

The timer can be used to play sound from the monitor after the specified number of hours has passed. The timer can be set to sound once or repeat at specified intervals.

Timer

Press ▲ or ▼ to select a setting, press OK to confirm.



Press [MENU] to exit programming.

Timer

The timer can be used to play sound from the monitor after the specified number of hours has passed. The timer can be set to sound once or repeat at specified intervals.

Timer

Press ▲ or ▼ to select a setting, press OK to confirm.



Press [MENU] to exit programming.

Timer

The timer can be used to play sound from the monitor after the specified number of hours has passed. The timer can be set to sound once or repeat at specified intervals.

Sensor Settings

Press ▲ or ▼ to select a menu item, press OK to confirm.



Press [MENU] to exit programming.

Sensors Settings

You can configure the sensors to match how you want the motion and sound to be detected. The sensor configurations will also affect how the auto lullaby and smart notification features operate.

Sensor Settings

Press ▲ or ▼ to select a menu item, press OK to confirm.



Press [MENU] to exit programming.

Sensors Settings

You can configure the sensors to match how you want the motion and sound to be detected. The sensor configurations will also affect how the auto lullaby and smart notification features operate.

Sensor Settings

Press ▲ or ▼ to select a menu item, press OK to confirm.



Press [MENU] to exit programming.

Sensors Settings

You can configure the sensors to match how you want the motion and sound to be detected. The sensor configurations will also affect how the auto lullaby and smart notification features operate.

Sensor Settings - Motion

Press ▲ or ▼ to select a menu item, press OK to confirm.



Press [MENU] to exit programming.

Configuring The Motion Sensor

You can specify the sensitivity of the motion sensor and which areas of images are used to detect motion.

Sensor Settings - Motion

Press ▲ or ▼ to select a menu item, press OK to confirm.



Press [MENU] to exit programming.

Configuring The Motion Sensor

You can specify the sensitivity of the motion sensor and which areas of images are used to detect motion.

Sensor Settings – Motion Sensitivity

Press OK to continue.

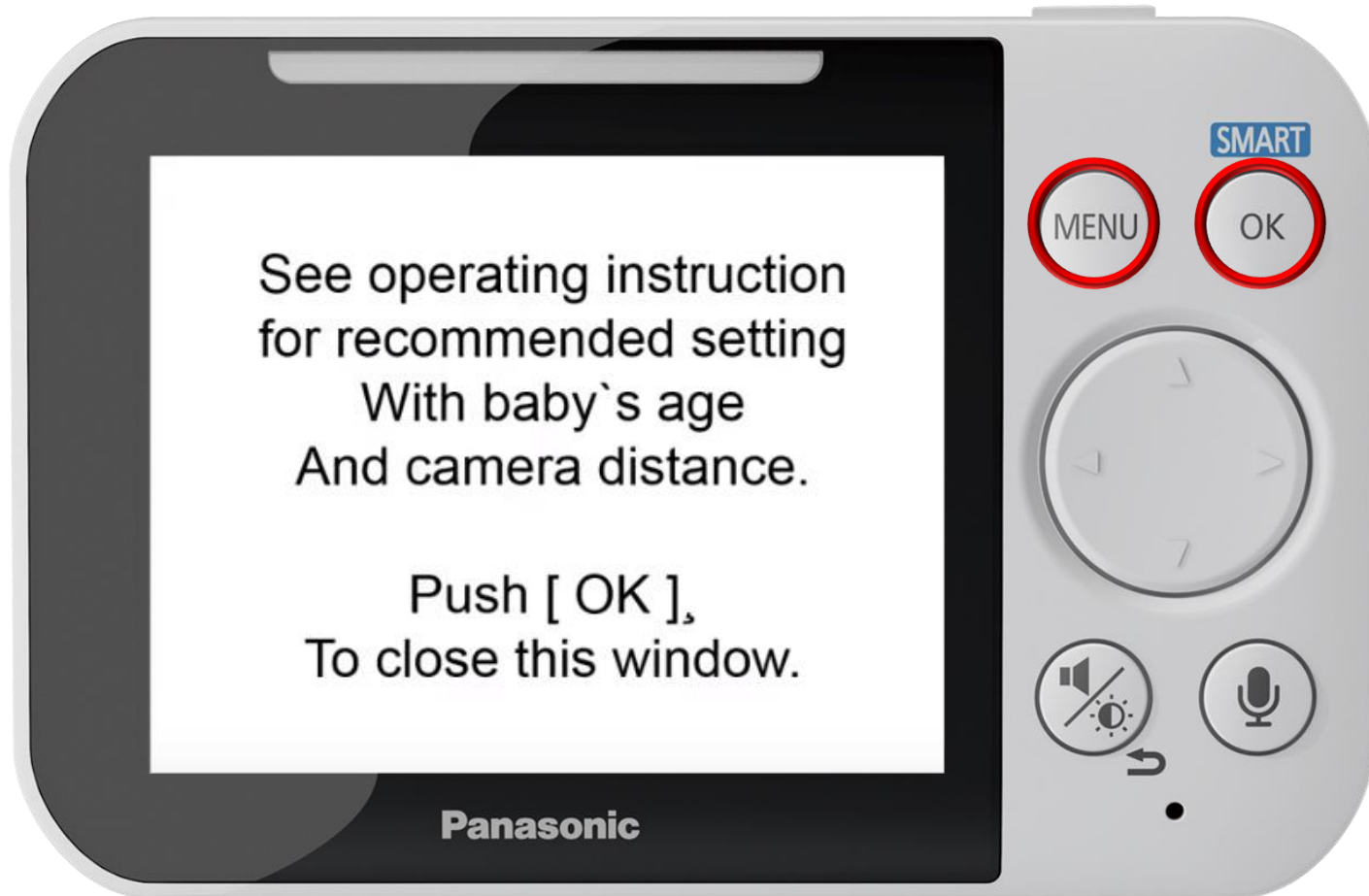

Press [MENU] to exit programming.

Configuring The Motion Sensor Sensitivity

Motion sensor sensitivity is configured using a combination of the distance from the camera to the baby and the age of the baby in months. Change the settings in accordance with the growth of the baby.

Sensor Settings – Motion Sensitivity

Press ▲ or ▼ to select a sensitivity level, press OK to confirm.



Press [MENU] to exit programming.

Configuring The Motion Sensor Sensitivity

Motion sensor sensitivity is configured using a combination of the distance from the camera to the baby and the age of the baby in months. Change the settings in accordance with the growth of the baby.

Sensor Settings – Motion Sensitivity

Press ▲ or ▼ to select a sensitivity level, press OK to confirm.



Press [MENU] to exit programming.

Configuring The Motion Sensor Sensitivity

Motion sensor sensitivity is configured using a combination of the distance from the camera to the baby and the age of the baby in months. Change the settings in accordance with the growth of the baby.

Sensor Settings – Motion Sensitivity

Press ▲ or ▼ to select a sensitivity level, press OK to confirm.



Press [MENU] to exit programming.

Configuring The Motion Sensor Sensitivity

Motion sensor sensitivity is configured using a combination of the distance from the camera to the baby and the age of the baby in months. Change the settings in accordance with the growth of the baby.

Sensor Settings – Motion Sensitivity

Press ▲ or ▼ to select a sensitivity level, press OK to confirm.



Press [MENU] to exit programming.

Configuring The Motion Sensor Sensitivity

Motion sensor sensitivity is configured using a combination of the distance from the camera to the baby and the age of the baby in months. Change the settings in accordance with the growth of the baby.

Sensor Settings – Motion Sensitivity

Press ▲ or ▼ to select a sensitivity level, press OK to confirm.



Press [MENU] to exit programming.

Configuring The Motion Sensor Sensitivity

Motion sensor sensitivity is configured using a combination of the distance from the camera to the baby and the age of the baby in months. Change the settings in accordance with the growth of the baby.

Sensor Settings – Motion Sensitivity

Press ▲ or ▼ to select a sensitivity level, press OK to confirm.



Press [MENU] to exit programming.

Configuring The Motion Sensor Sensitivity

Motion sensor sensitivity is configured using a combination of the distance from the camera to the baby and the age of the baby in months. Change the settings in accordance with the growth of the baby.

Sensor Settings – Motion Sensitivity

Press ▲ or ▼ to select a sensitivity level, press OK to confirm.



Press [MENU] to exit programming.

Configuring The Motion Sensor Sensitivity

Motion sensor sensitivity is configured using a combination of the distance from the camera to the baby and the age of the baby in months. Change the settings in accordance with the growth of the baby.

Sensor Settings – Set Motion Detection Area

Press OK to continue.

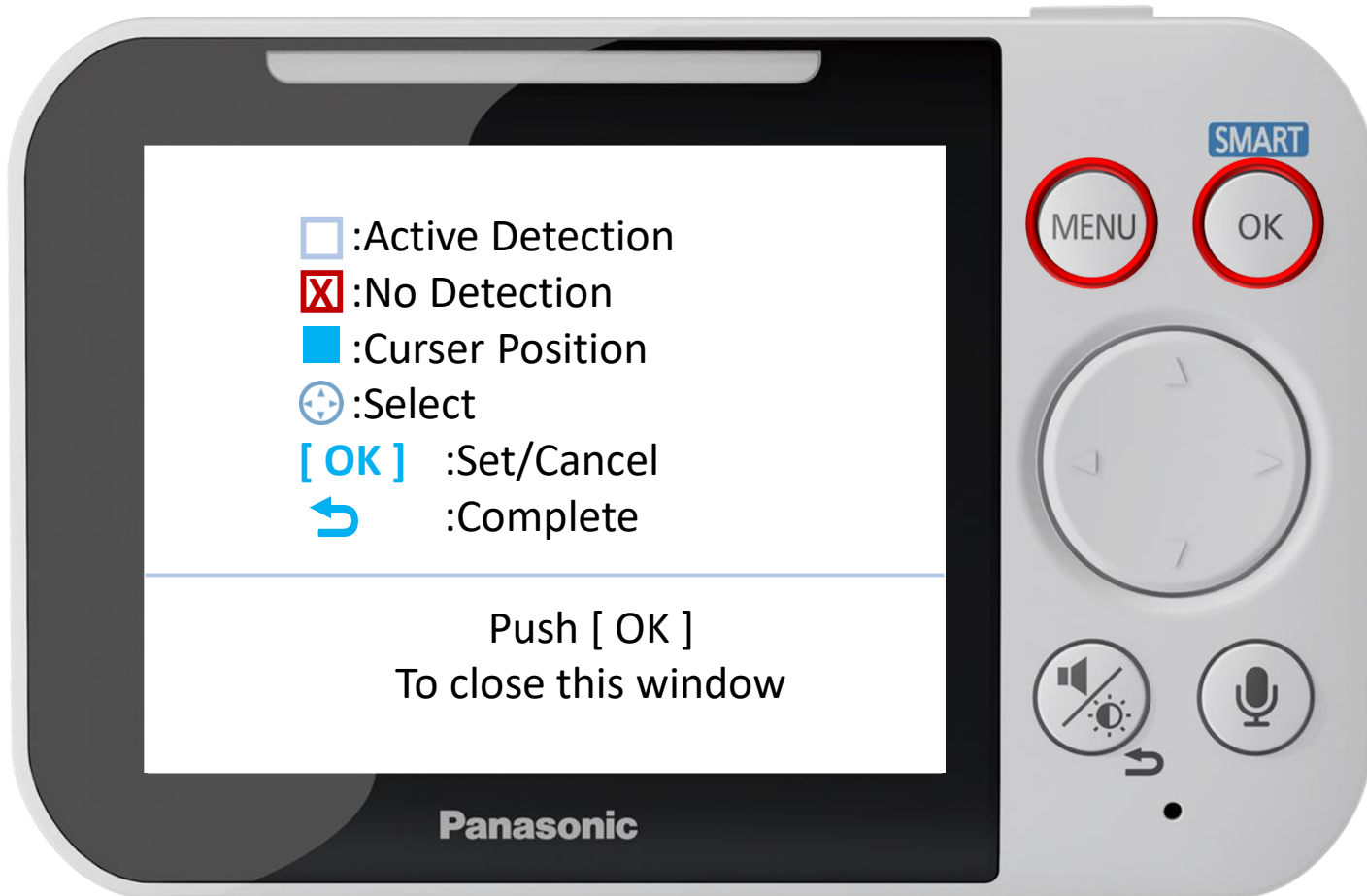

Press [MENU] to exit programming.

Configuring the Motion Detection Area

Indicators and controls.

Sensor Settings – Set Motion Detection Area

Press ▼ ▲ to navigate, press OK to select, press [MENU] to exit.



Configuring The Motion Detection Area

Select which areas of images are used to detect motion.

(In this simulator only the first row is selectable.)

Sensor Settings – Set Motion Detection Area

Press ▼ ▲ to navigate, press OK to select, press [MENU] to exit.



Configuring The Motion Detection Area

Select which areas of images are used to detect motion.

(In this simulator only the first row is selectable.)

Sensor Settings – Set Motion Detection Area

Press ▼ ▲ to navigate, press OK to select, press [MENU] to exit.



Configuring The Motion Detection Area

Select which areas of images are used to detect motion.
(In this simulator only the first row is selectable.)

Sensor Settings – Set Motion Detection Area

Press ▼ ▲ to navigate, press OK to select, press [MENU] to exit.



Configuring The Motion Detection Area

Select which areas of images are used to detect motion.

(In this simulator only the first row is selectable.)

Sensor Settings – Set Motion Detection Area

Press ▼ ▲ to navigate, press OK to select, press [MENU] to exit.



Configuring The Motion Detection Area

Select which areas of images are used to detect motion.

(In this simulator only the first row is selectable.)

Sensor Settings – Set Motion Detection Area

Press ▼ ▲ to navigate, press OK to select, press [MENU] to exit.



Configuring The Motion Detection Area

Select which areas of images are used to detect motion.

(In this simulator only the first row is selectable.)

Sensor Settings – Set Motion Detection Area

Press ▼ ▲ to navigate, press OK to select, press [MENU] to exit.



Configuring The Motion Detection Area

Select which areas of images are used to detect motion.

(In this simulator only the first row is selectable.)

Sensor Settings – Set Motion Detection Area

Press ▼ ▲ to navigate, press OK to select, press [MENU] to exit.



Configuring The Motion Detection Area

Select which areas of images are used to detect motion.

(In this simulator only the first row is selectable.)

Sensor Settings – Sound Sensitivity

Press ▲ or ▼ to select a sensitivity level, press OK to confirm.



Press [MENU] to exit programming.

Configuring The Sound Sensor

You can specify the sensitivity of the sound sensor.

Sensor Settings – Sound Sensitivity

Press ▲ or ▼ to select a sensitivity level, press OK to confirm.



Press [MENU] to exit programming.

Configuring The Sound Sensor

You can specify the sensitivity of the sound sensor.

Sensor Settings – Sound Sensitivity

Press ▲ or ▼ to select a sensitivity level, press OK to confirm.



Press [MENU] to exit programming.

Configuring The Sound Sensor

You can specify the sensitivity of the sound sensor.

Sensor Settings – Sound Sensitivity

Press ▲ or ▼ to select a sensitivity level, press OK to confirm.



Press [MENU] to exit programming.

Configuring The Sound Sensor

You can specify the sensitivity of the sound sensor.

Sensor Settings – Sound Sensitivity

Press ▲ or ▼ to select a sensitivity level, press OK to confirm.



Configuring The Sound Sensor

You can specify the sensitivity of the sound sensor.

Press [MENU] to exit programming.

Sensor Settings – Sound Sensitivity

Press ▲ or ▼ to select a sensitivity level, press OK to confirm.



Press [MENU] to exit programming.

Configuring The Sound Sensor

You can specify the sensitivity of the sound sensor.

Sensor Settings - Temperature Sensor

Press ▲ or ▼ to select a menu item, press OK to confirm.



Press [MENU] to exit programming.

Configuring The Temperature Sensor

You can specify how the temperature units (Celsius or Fahrenheit) are displayed on the monitor and set the alert range.

Sensor Settings - Temperature Sensor

Press ▲ or ▼ to select a menu item, press OK to confirm.



Press [MENU] to exit programming.

Configuring The Temperature Sensor

You can specify how the temperature units (Celsius or Fahrenheit) are displayed on the monitor and set the alert range.

Temperature Units

Press ▲ or ▼ to select a setting, press OK to confirm.



Press [MENU] to exit programming.

Configuring The Temperature Units

You can specify how the temperature units (Celsius or Fahrenheit) are displayed on the monitor.

Temperature Units

Press ▲ or ▼ to select a setting, press OK to confirm.



Press [MENU] to exit programming.

Configuring The Temperature Units

You can specify how the temperature units (Celsius or Fahrenheit) are displayed on the monitor.

Temperature Alert Range

Press ▲ or ▼ to select a limit, press OK to complete.

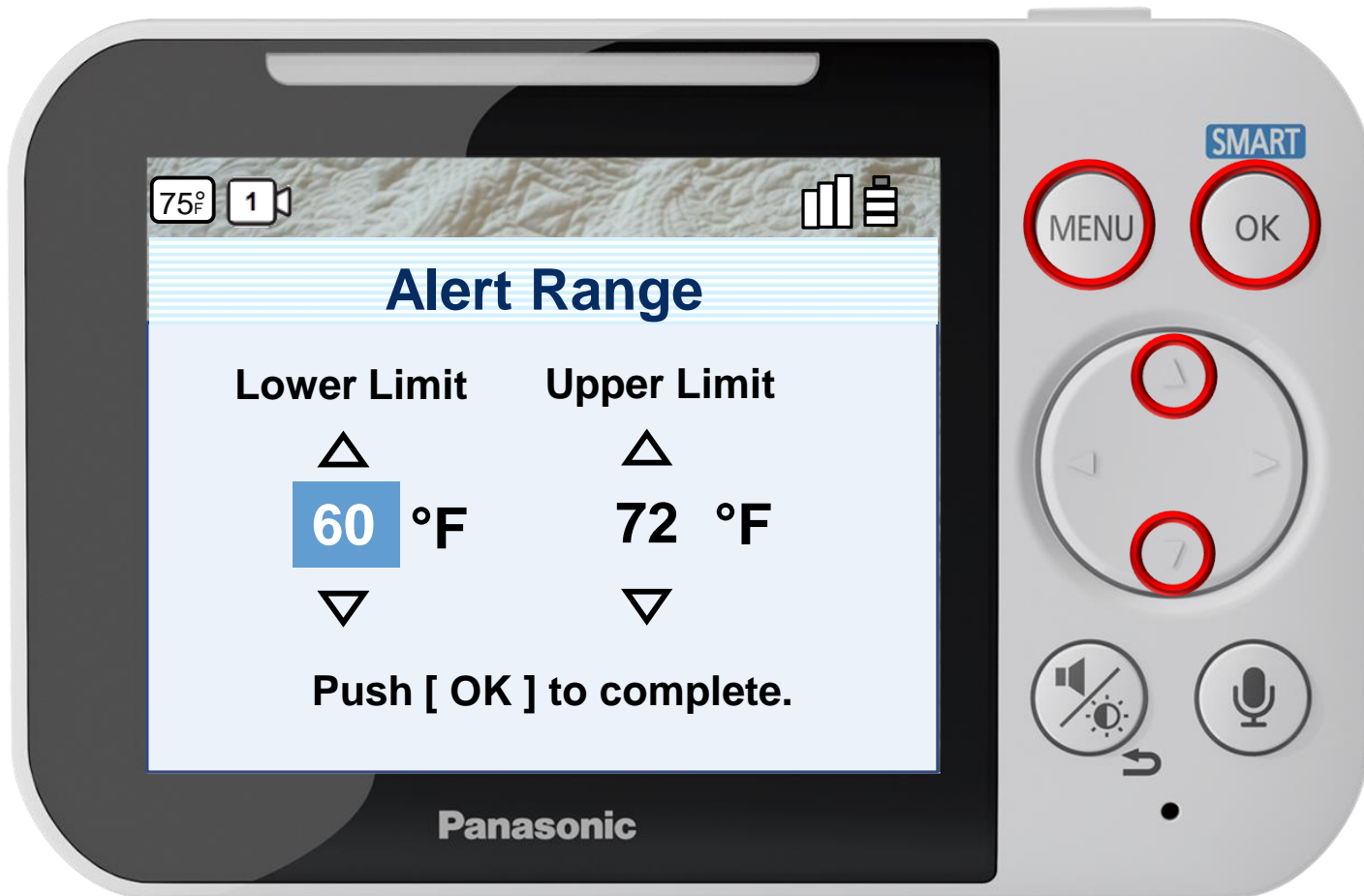

Press [MENU] to exit programming.

Configuring The Temperature Alert Range

For the alert range, specify an upper and lower limit.

(In this simulator only the lower limit is selectable by 2 degrees either way.)

Temperature Alert Range

Press ▲ or ▼ to select a limit, press OK to complete.



Press [MENU] to exit programming.

Configuring The Temperature Alert Range

For the alert range, specify an upper and lower limit.

(In this simulator only the lower limit is selectable by 2 degrees either way.)

Temperature Alert Range

Press ▲ or ▼ to select a limit, press OK to complete.



Press [MENU] to exit programming.

Configuring The Temperature Alert Range

For the alert range, specify an upper and lower limit.

(In this simulator only the lower limit is selectable by 2 degrees either way.)

Temperature Alert Range

Press ▲ or ▼ to select a limit, press OK to complete.



Press [MENU] to exit programming.

Configuring The Temperature Alert Range

For the alert range, specify an upper and lower limit.

(In this simulator only the lower limit is selectable by 2 degrees either way.)

Temperature Alert Range

Press ▲ or ▼ to select a limit, press OK to complete.



Press [MENU] to exit programming.

Configuring The Temperature Alert Range

For the alert range, specify an upper and lower limit.

(In this simulator only the lower limit is selectable by 2 degrees either way.)

Camera Speaker Volume

Press ► or ◀ to select a level, press OK to complete.



Press [MENU] to exit programming.

Camera Speaker Volume

Press ► or ◀ to select a level, press OK to complete.



Press [MENU] to exit programming.

Camera Speaker Volume

Press ► or ◀ to select a level, press OK to complete.



Press [MENU] to exit programming.

Camera Speaker Volume

Press ► or ◀ to select a level, press OK to complete.



Press [MENU] to exit programming.

Camera Speaker Volume

Press ► or ◀ to select a level, press OK to complete.



Press [MENU] to exit programming.

Camera Speaker Volume

Press ► or ◀ to select a level, press OK to complete.



Press [MENU] to exit programming.

Camera Speaker Volume

Press ► or ◀ to select a level, press OK to complete.



Press [MENU] to exit programming.

Camera Brightness

Press ► or ◀ to select a level, press OK to complete.



Press [MENU] to exit programming.

Adjusting The Camera Brightness

Brightness can be adjusted through the MENU or by selecting the Volume/Brightness  button.

Camera Brightness

Press ► or ◀ to select a level, press OK to complete.



Press [MENU] to exit programming.

Adjusting The Camera Brightness

Brightness can be adjusted through the MENU or by selecting the Volume/Brightness  button.

Camera Brightness

Press ► or ◀ to select a level, press OK to complete.



Press [MENU] to exit programming.

Adjusting The Camera Brightness

Brightness can be adjusted through the MENU or by selecting the Volume/Brightness  button.

Camera Brightness

Press ► or ◀ to select a level, press OK to complete.



Press [MENU] to exit programming.

Adjusting The Camera Brightness

Brightness can be adjusted through the MENU or by selecting the Volume/Brightness  button.

Camera Brightness

Press ► or ◀ to select a level, press OK to complete.



Press [MENU] to exit programming.

Adjusting The Camera Brightness

Brightness can be adjusted through the MENU or by selecting the Volume/Brightness  button.

Camera Brightness

Press ► or ◀ to select a level, press OK to complete.



Press [MENU] to exit programming.

Adjusting The Camera Brightness

Brightness can be adjusted through the MENU or by selecting the Volume/Brightness  button.

Camera Management

Press ▲ or ▼ to select a menu item, press OK to confirm.



Press [MENU] to exit programming.

Managing Cameras

Up to 3 additional cameras can be registered to the monitor unit.

Camera Management

Press ▲ or ▼ to select a menu item, press OK to confirm.



Press [MENU] to exit programming.

Managing Cameras

Up to 3 additional cameras can be registered to the monitor unit.

Camera Management

Press ▲ or ▼ to select a menu item, press OK to confirm.



Press [MENU] to exit programming.

Managing Cameras

Up to 3 additional cameras can be registered to the monitor unit.

Camera Management – Add Camera

Press OK to begin pairing.



Press [MENU] to exit programming.

Add Camera

Up to 3 additional cameras can be registered to the monitor unit.

Camera Management – Add Camera

Press OK to begin pairing.

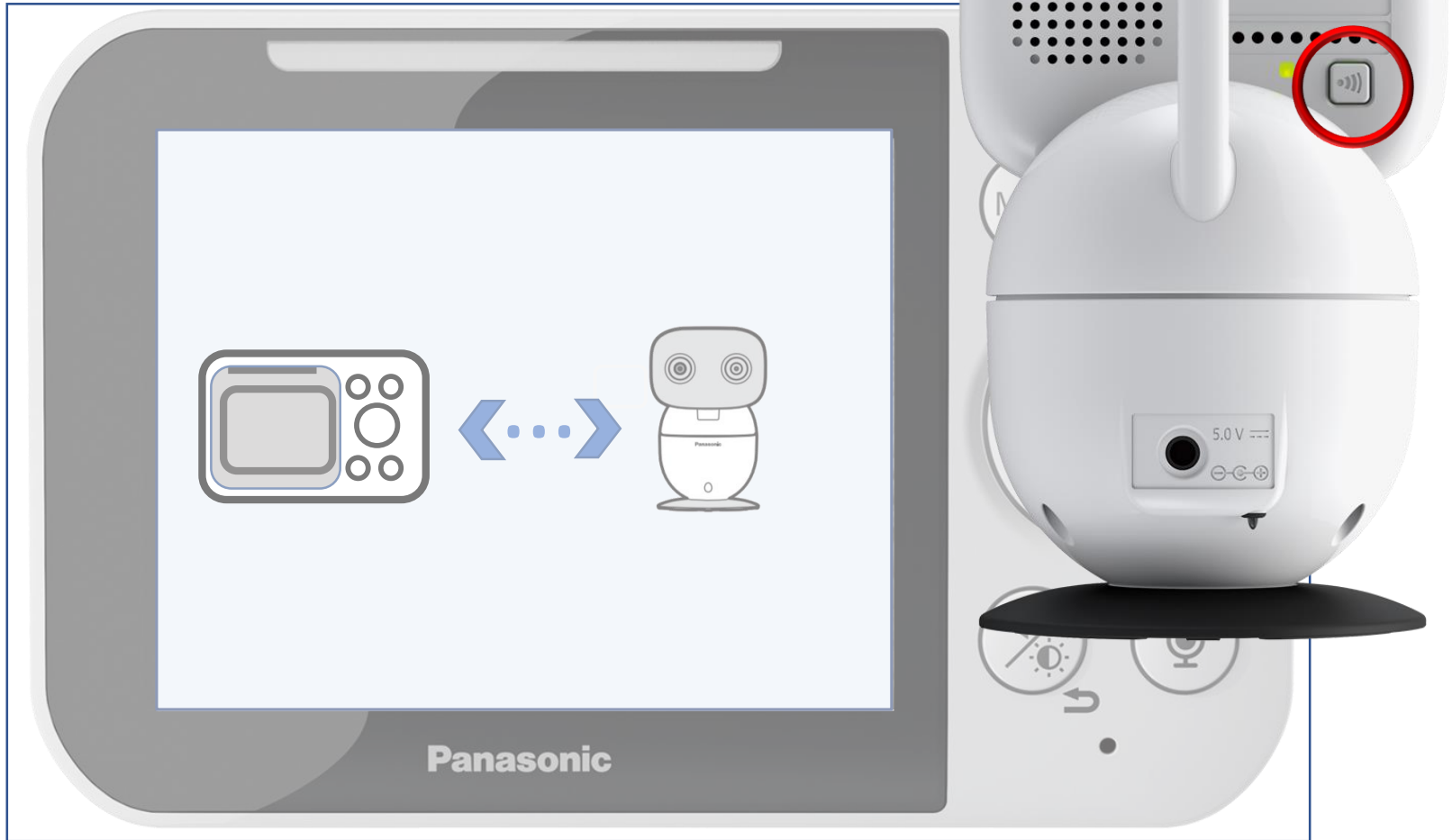

Add Camera

The pairing button on the camera must be pressed within 90 seconds after pressing the [OK] button.

Camera Management – Add Camera

This process is automatic.



Add Camera

1 Pairing Successful will be displayed, 2 then Connecting.

Press to continue

Camera Management – Add Camera

Pairing is complete.



Add Camera

The camera number is displayed.

Press [MENU] to exit programming.

Delete Camera

Press ► to select [Yes].



Press [MENU] to exit programming.

Deleting a Camera

You can delete cameras that are no longer needed.

Note: Only the currently connected camera is deleted. To delete other cameras, select the displayed camera and then delete that camera.

Delete Camera

Press OK to complete.



Press [MENU] to exit programming.

Deleting a Camera

You can delete cameras that are no longer needed.

Note: Only the currently connected camera is deleted. To delete other cameras, select the displayed camera and then delete that camera.

Camera Reset

Press ► to select [Yes].



Press [MENU] to exit programming.

Resetting a Camera

The camera unit settings saved on a monitor unit can be reset.

Note: All camera unit settings except for registration settings are reset. Settings for all camera units registered to the monitor unit are reset.

Camera Reset

Press OK to complete.



Press [MENU] to exit programming.

Resetting a Camera

The camera unit settings saved on a monitor unit can be reset.

Note: All camera unit settings except for registration settings are reset. Settings for all camera units registered to the monitor unit are reset.

Monitor Settings

Press ▲ or ▼ to select a Menu item, press OK to confirm.



Press [MENU] to exit programming.

Monitor Settings

Press ▲ or ▼ to select a Menu item, press OK to confirm.



Press [MENU] to exit programming.

Monitor Settings

Press ▲ or ▼ to select a Menu item, press OK to confirm.



Press [MENU] to exit programming.

Monitor Settings

Press ▲ or ▼ to select a Menu item, press OK to confirm.



Press [MENU] to exit programming.

Monitor Settings – Sleep Mode

Press ▲ or ▼ to select a sleep time, press OK to confirm.



Press [MENU] to exit programming.

Adjusting The Sleep Mode

Sleep mode is used to automatically turn off the display of the monitor when the monitor has been inactive for a specific period of time. You can select how long the monitor is inactive for before it enters sleep mode or turn off sleep mode.

Monitor Settings – Sleep Mode

Press ▲ or ▼ to select a sleep time, press OK to confirm.



Press [MENU] to exit programming.

Adjusting The Sleep Mode

Sleep mode is used to automatically turn off the display of the monitor when the monitor has been inactive for a specific period of time. You can select how long the monitor is inactive for before it enters sleep mode or turn off sleep mode.

Monitor Settings – Sleep Mode

Press ▲ or ▼ to select a sleep time, press OK to confirm.

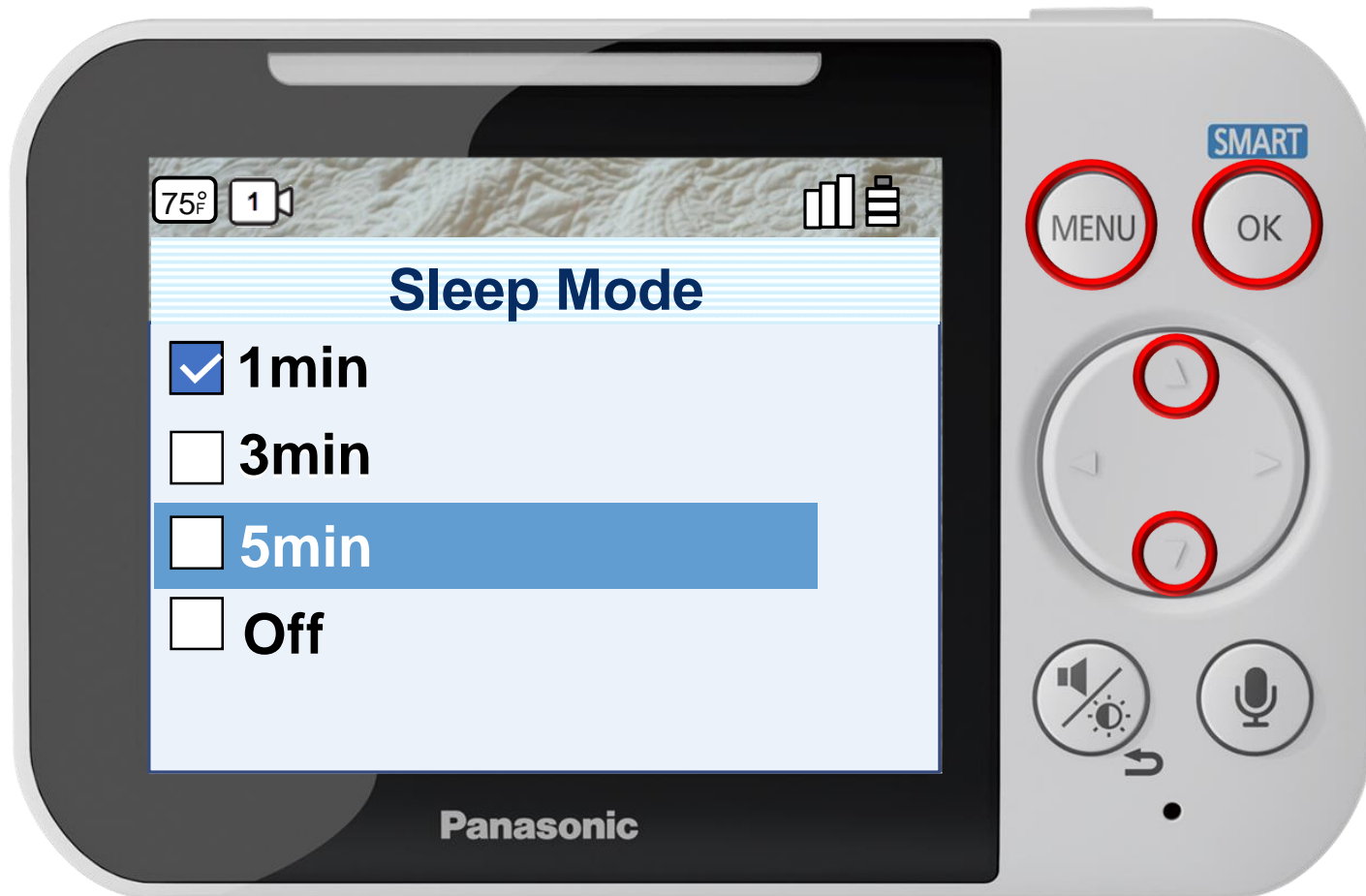

Press [MENU] to exit programming.

Adjusting The Sleep Mode

Sleep mode is used to automatically turn off the display of the monitor when the monitor has been inactive for a specific period of time. You can select how long the monitor is inactive for before it enters sleep mode or turn off sleep mode.

Monitor Settings – Sleep Mode

Press ▲ or ▼ to select a sleep time, press OK to confirm.



Press [MENU] to exit programming.

Adjusting The Sleep Mode

Sleep mode is used to automatically turn off the display of the monitor when the monitor has been inactive for a specific period of time. You can select how long the monitor is inactive for before it enters sleep mode or turn off sleep mode.

Monitor Settings – Beep Volume

Press ▲ or ▼ to select a volume level, press OK to confirm.

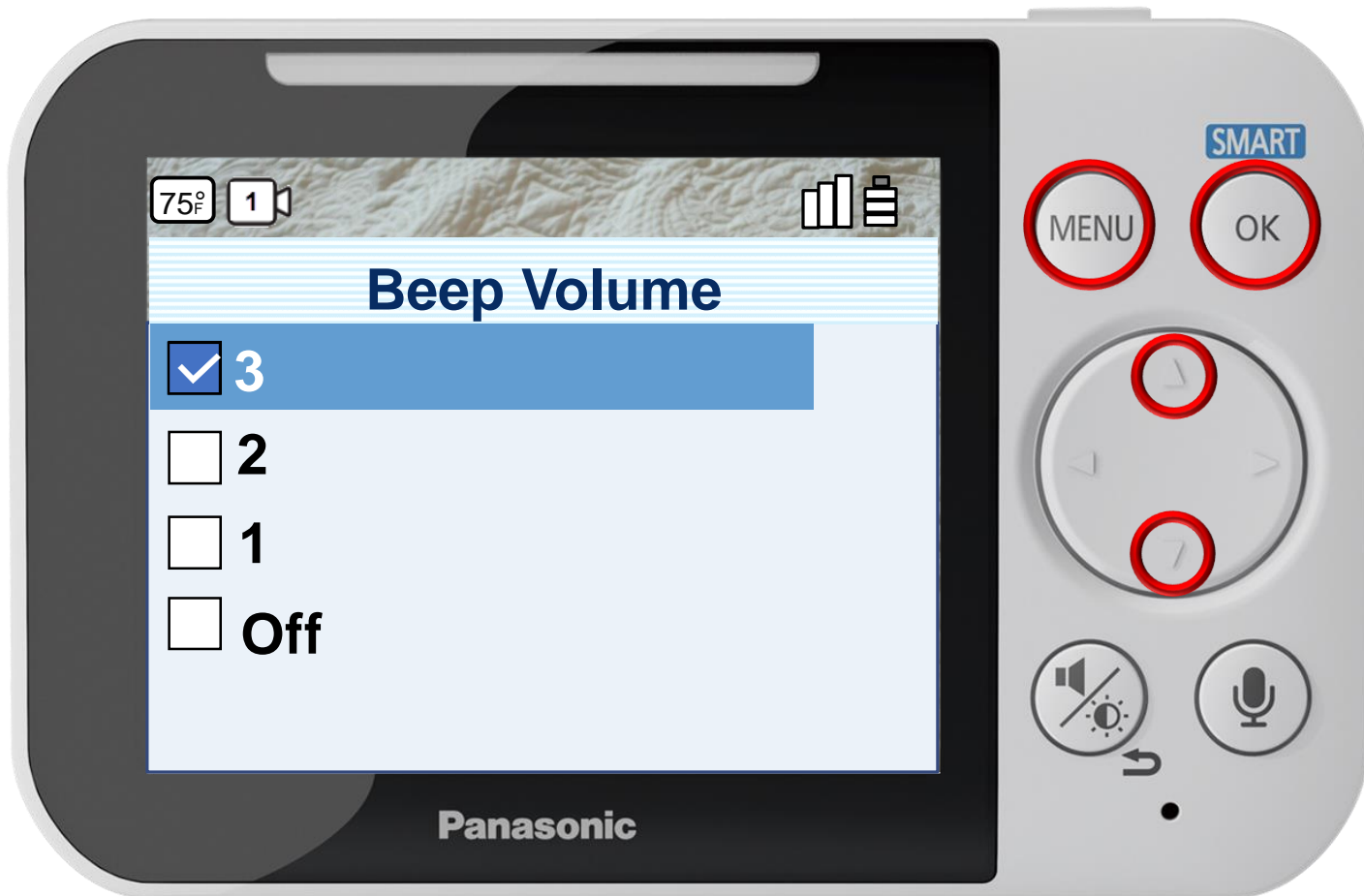

Press [MENU] to exit programming.

Adjusting The Chime/Beep Volume

The monitor plays chimes and beeps to indicate the status of the monitor and camera sensors. You can adjust the volume of chimes/beeps or turn them off.

Monitor Settings – Beep Volume

Press ▲ or ▼ to select a volume level, press OK to confirm.

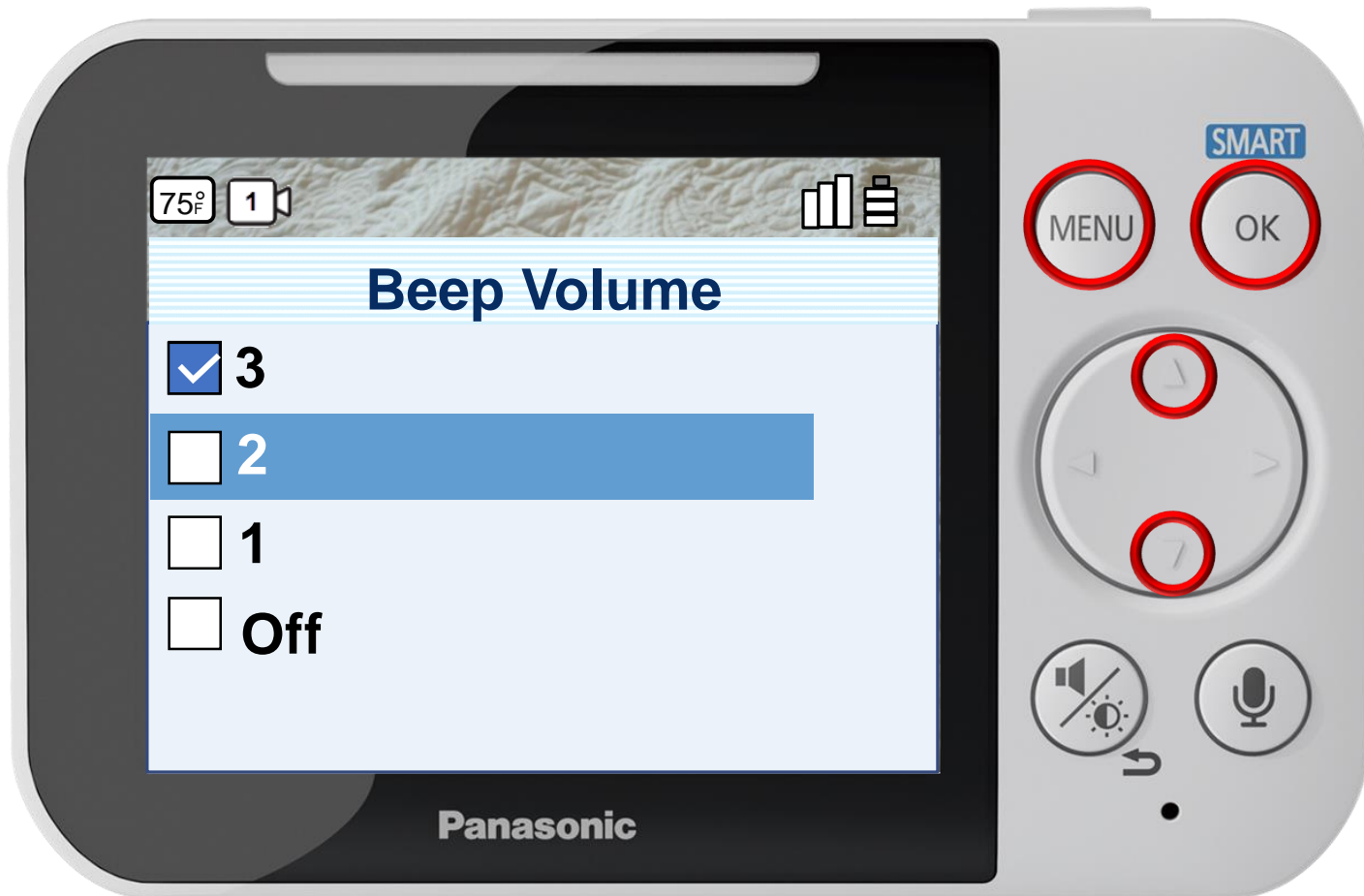

Press [MENU] to exit programming.

Adjusting The Chime/Beep Volume

The monitor plays chimes and beeps to indicate the status of the monitor and camera sensors. You can adjust the volume of chimes/beeps or turn them off.

Monitor Settings – Beep Volume

Press ▲ or ▼ to select a volume level, press OK to confirm.

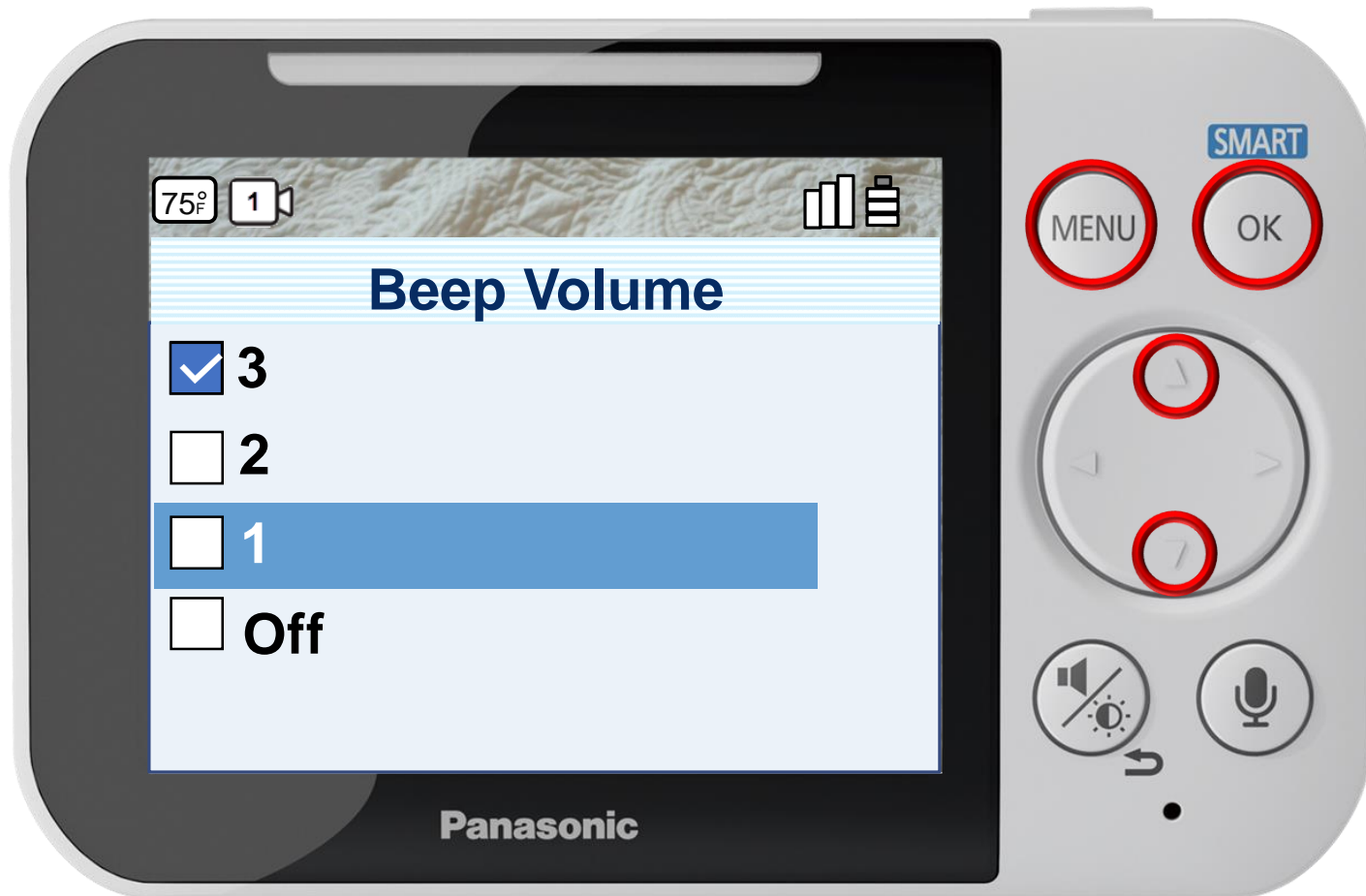

Press [MENU] to exit programming.

Adjusting The Chime/Beep Volume

The monitor plays chimes and beeps to indicate the status of the monitor and camera sensors. You can adjust the volume of chimes/beeps or turn them off.

Monitor Settings – Beep Volume

Press ▲ or ▼ to select a volume level, press OK to confirm.

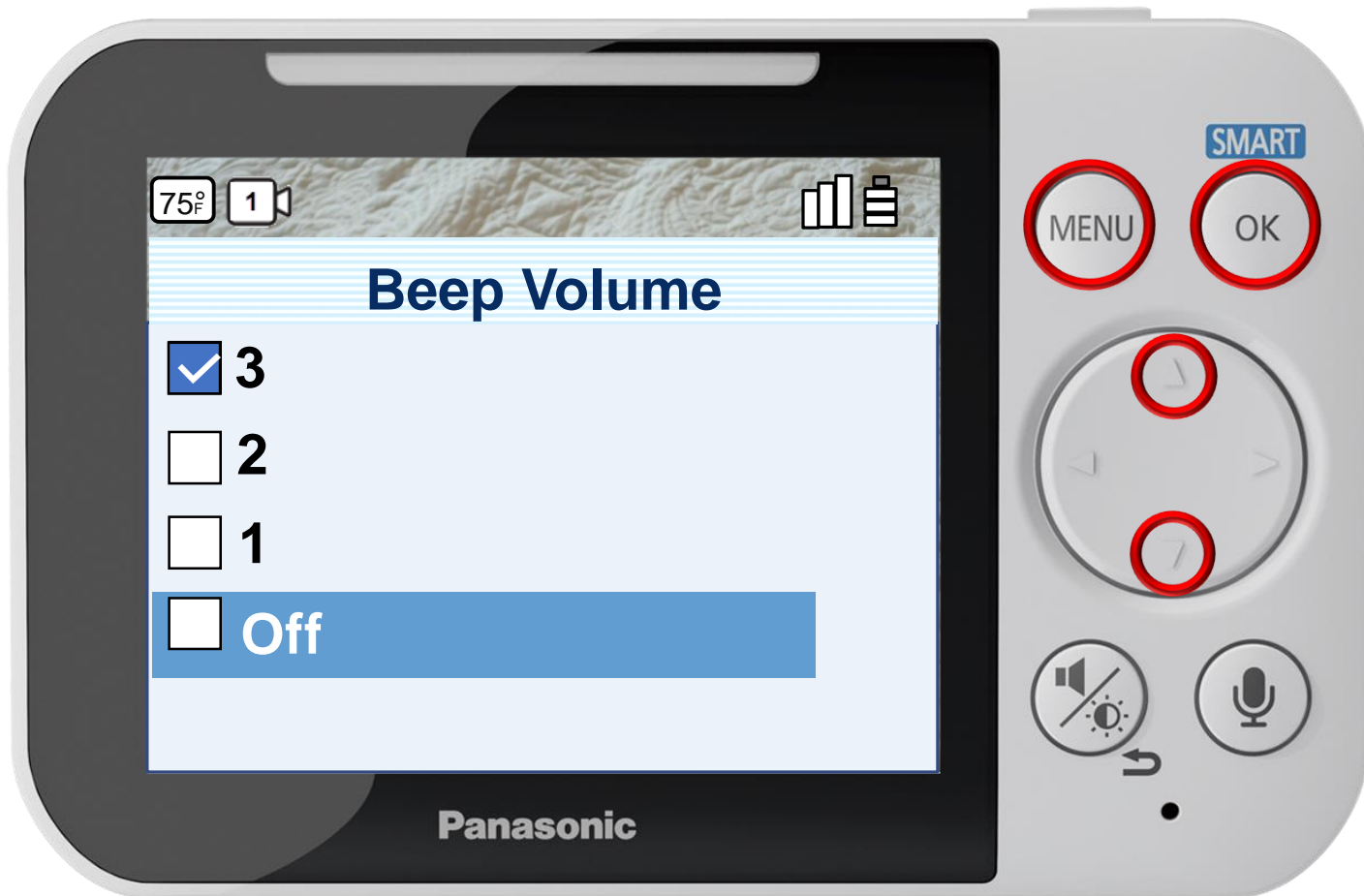

Press [MENU] to exit programming.

Adjusting The Chime/Beep Volume

The monitor plays chimes and beeps to indicate the status of the monitor and camera sensors. You can adjust the volume of chimes/beeps or turn them off.

Monitor Settings – Language

Press ▲ or ▼ to select a Language, press OK to confirm.



Press [MENU] to exit programming.

Adjusting The Language

For this simulation, the screens will remain in English no matter which language you select.

Monitor Settings – Language

Press ▲ or ▼ to select a Language, press OK to confirm.



Press [MENU] to exit programming.

Adjusting The Language

For this simulation, the screens will remain in English no matter which language you select.

Monitor Settings – Language

Press ▲ or ▼ to select a Language, press OK to confirm.



Press [MENU] to exit programming.

Adjusting The Language

For this simulation, the screens will remain in English no matter which language you select.

Monitor Settings – Speaker Volume

Press ► or ◀ to select a level, press OK to complete.



Press [MENU] to exit programming.

Adjusting The Monitor Volume

Volume can be adjusted through the MENU or by selecting the Volume/Brightness  button.

Monitor Settings – Speaker Volume

Press ► or ◀ to select a level, press OK to complete.



Press [MENU] to exit programming.

Adjusting The Monitor Volume

Volume can be adjusted through the MENU or by selecting the Volume/Brightness  button.

Monitor Settings – Speaker Volume

Press ► or ◀ to select a level, press OK to complete.



Press [MENU] to exit programming.

Adjusting The Monitor Volume

Volume can be adjusted through the MENU or by selecting the Volume/Brightness  button.

Monitor Settings – Speaker Volume

Press ► or ◀ to select a level, press OK to complete.



Press [MENU] to exit programming.

Adjusting The Monitor Volume

Volume can be adjusted through the MENU or by selecting the Volume/Brightness  button.

Monitor Settings – Speaker Volume

Press ► or ◀ to select a level, press OK to complete.



Press [MENU] to exit programming.

Adjusting The Monitor Volume

Volume can be adjusted through the MENU or by selecting the Volume/Brightness  button.

Monitor Settings – Speaker Volume

Press ► or ◀ to select a level, press OK to complete.



Press [MENU] to exit programming.

Adjusting The Monitor Volume

Volume can be adjusted through the MENU or by selecting the Volume/Brightness  button.

Camera Select

Press ► or ◀ to select a camera, press OK to connect.



Press [MENU] to exit programming.

Selecting Cameras and Using Auto Scan

If there are multiple cameras registered to the monitor, you can select which camera images to view and use auto scan. Auto scan automatically switches images from each camera every 10 seconds.

Camera Select

Press ► or ◀ to select a camera, press OK to connect.



Press [MENU] to exit programming.

Selecting Cameras and Using Auto Scan

If there are multiple cameras registered to the monitor, you can select which camera images to view and use auto scan. Auto scan automatically switches images from each camera every 10 seconds.

Camera Select

Press ► or ◀ to select a camera, press OK to connect.



Press [MENU] to exit programming.

Selecting Cameras and Using Auto Scan

If there are multiple cameras registered to the monitor, you can select which camera images to view and use auto scan. Auto scan automatically switches images from each camera every 10 seconds.

Camera Select

Press ► or ◀ to select a camera, press OK to connect.



Press [MENU] to exit programming.

Selecting Cameras and Using Auto Scan

If there are multiple cameras registered to the monitor, you can select which camera images to view and use auto scan. Auto scan automatically switches images from each camera every 10 seconds.

Camera Select

Press ► or ◀ to select a camera, press OK to connect.



Press [MENU] to exit programming.

Selecting Cameras and Using Auto Scan

If there are multiple cameras registered to the monitor, you can select which camera images to view and use auto scan. Auto scan automatically switches images from each camera every 10 seconds.

Information

Press [MENU] to exit.



Information

Displays customer support web address.